

50x10mm Wall Plate for Glass Balustrade Offset Rail



DIYGLASS
www.diyglass.com.au

50x10mm Wall Plate for Glass Offset Rail



DIYGLASS
www.diyglass.com.au

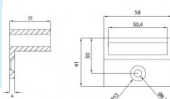

- Joins 50x10mm Tube to a wall or flat post
- 316 grade Stainless Steel
- Fit by Welding or epoxy glue
- Available in Mirror or satin finish

Rating: Not Rated Yet

Price

\$13.10

\$13.10

[Ask a question about this product](#)

Description

- Joins 50x10mm Tube to a wall or flat post
- 316 grade Stainless Steel
- Fit by Welding or epoxy glue
- Available in Mirror or satin finish