

AVAILABLE FROM



**Glassvice<sup>®</sup>**  
**Glass Clamp**

# Glass Vice<sup>®</sup> Products Ltd.

## Installation Manual.

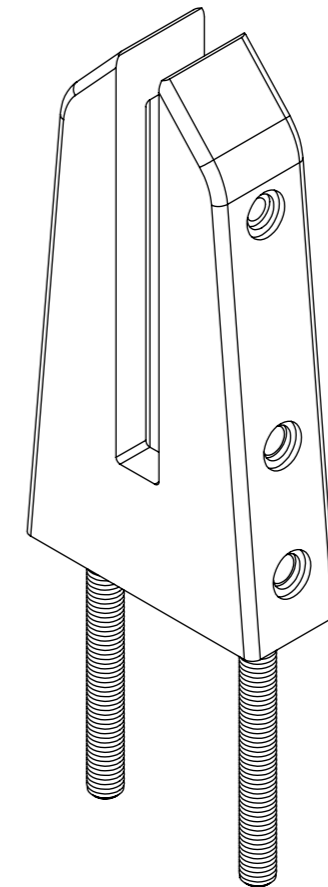

**Glassvice<sup>®</sup>**  
**Glass Clamp**

# Glass Vice® Products Ltd.

## Attachment of Interchangeable Bases & Threaded Rods

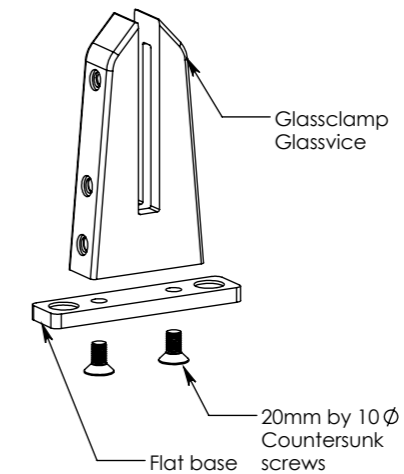

Before attachment of any of the interchangeable bases a layer of prolan protective lanolin (or similar) must be applied between the Glass Vice® glass clamp & base.

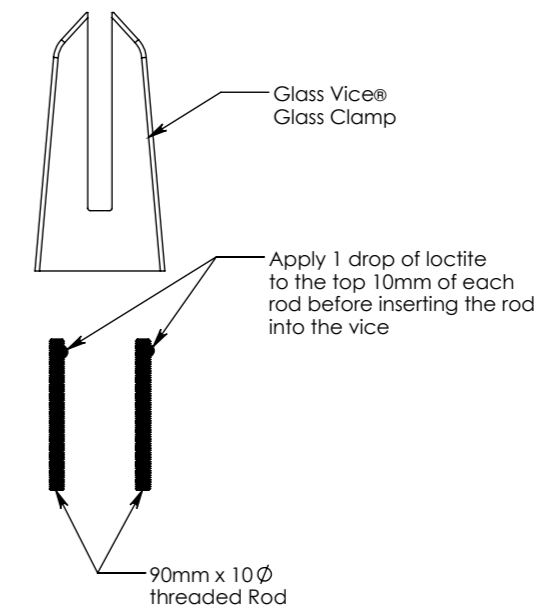

Before attachment of 100mm threaded rod apply a drop of loctite to each of the threaded rods to be screwed into the base of clamp.

When threaded rods are inserted into the Glass Vice® glass clamp make sure they will not interfere with the path of the grub screws.

## Direct fixing of Glass Vice® Glassclamp into concrete

A timber template is required for precise drilling of 95mm deep x 20  $\phi$  mm holes into which the threaded rods protruding from the Glass Vice® Glass Clamp base are inserted.

### Setup and layout of timber template

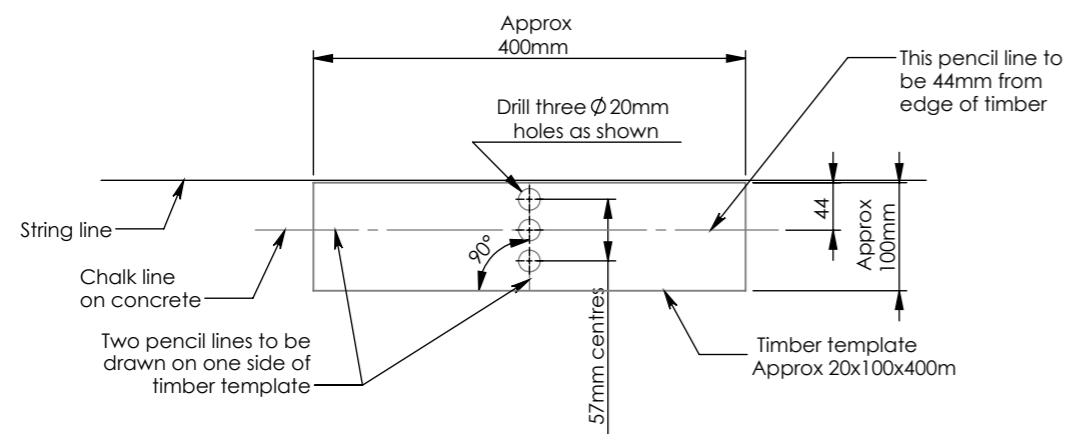

The drawing shows two ways of using the timber template. You will be working with a stringline or a chalk line.

Drill three 20  $\phi$  holes in timber template as shown above.

Centre hole is to sight the centre gap of the clamp. The long pencil line is to line up with the chalk line. The edge of the timber to butt up to the string line.

## How to Use a Timber Template

### Chalk Line

If using a chalk line the centre of the Glass Vice® glass clamp is marked on the chalk line. Use the middle hole to sight the centre mark.

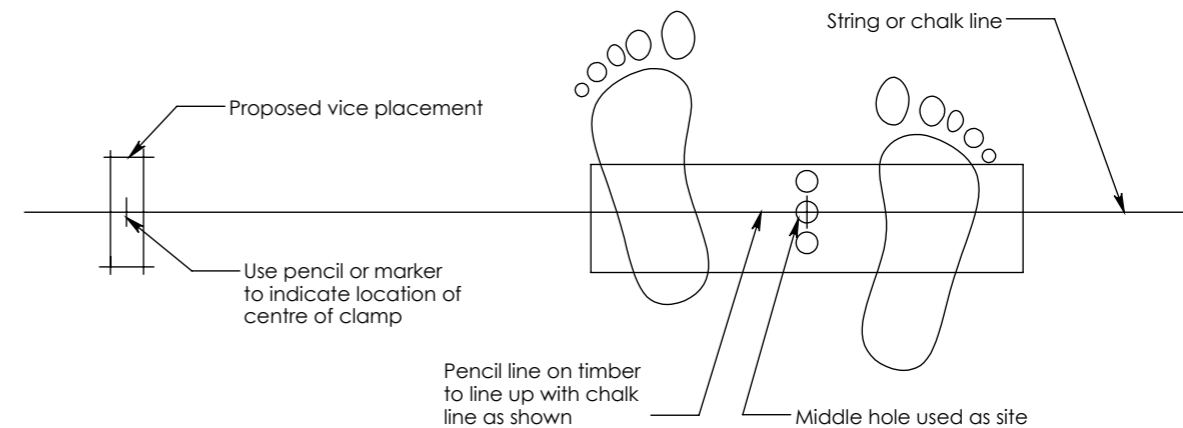

### String Line

The centre of the Glass Vice® glass clamp to be 44mm away from stringline.

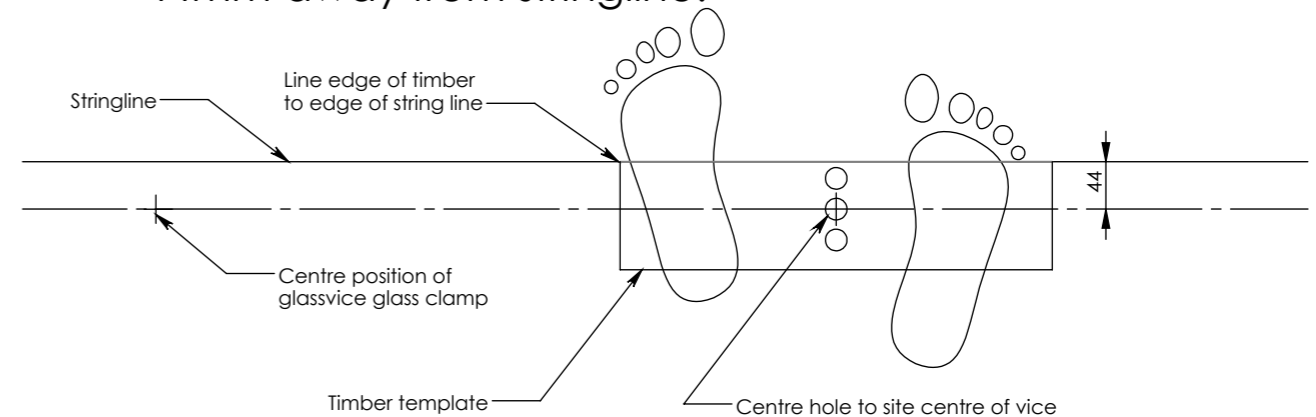

## Drilling Holes

Once layout of Glass Vice® glass clamp is decided, position timber template. With one foot on each side of the template you are now able to drill two 95mm deep holes using 20  $\phi$  mm masonry bit. The holes must then be blown out with a compressor & air hose to remove all the concrete dust.

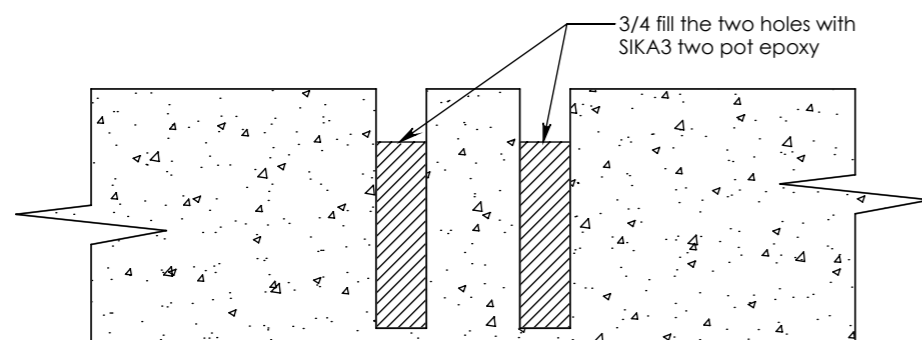
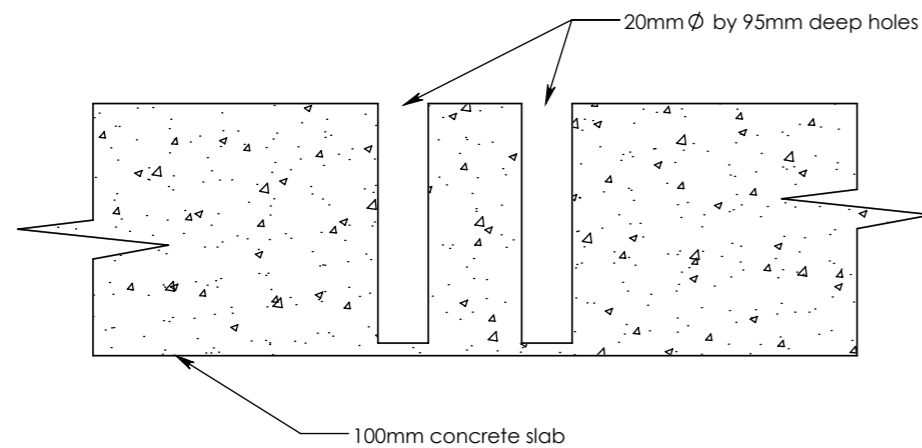

Then fill each hole with epoxy until epoxy is about 25mm from top of hole.

Insert threaded rod's into the two holes then remove. This will eliminate the air pockets in the epoxy.

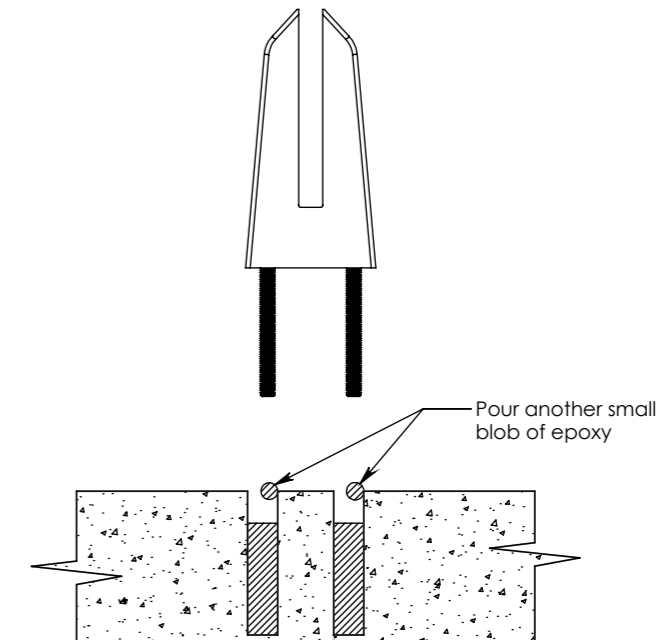

Then pour another small blob of epoxy at the top of holes. Then insert threaded rods into holes ready for plumbing and squaring.

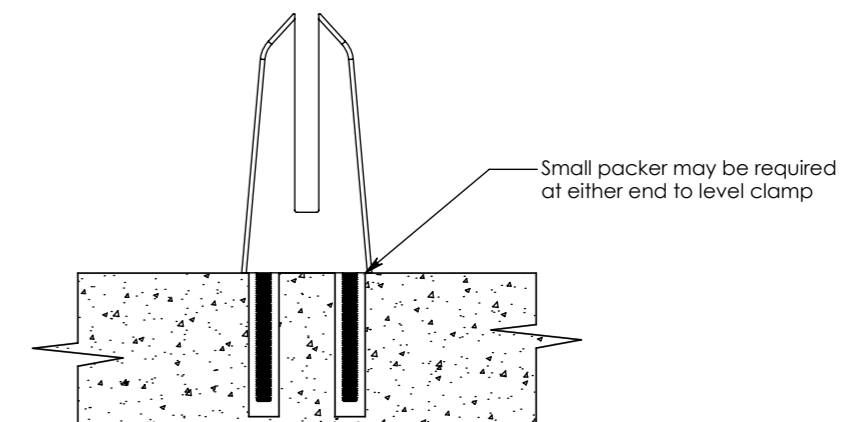

# Glass Vice® Products Ltd.

When positioning clamp close to the edge of concrete slab the centre of the closest threaded rod must be no less than 50mm from the edge of the concrete slab.

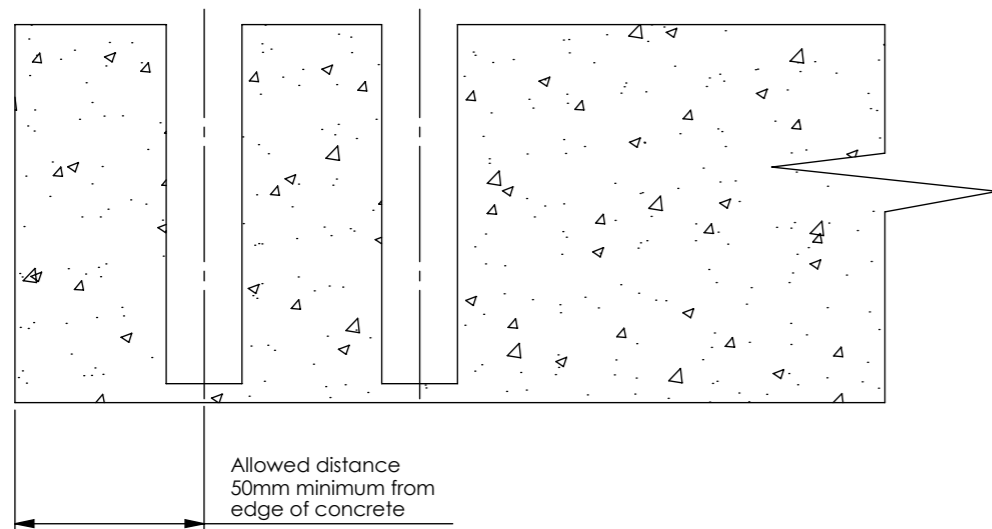

You are now ready to plumb and square up the Glass Vice® glass clamp. A builders square is the ideal tool for this job.

# Glass Vice® Products Ltd.

## Plumbing & Levelling of Glass Vice® glass clamp

A builder's square is ideal for this purpose. The clamp must be square to the line (stringline/chalk line) and levelled on both sides.

### Example

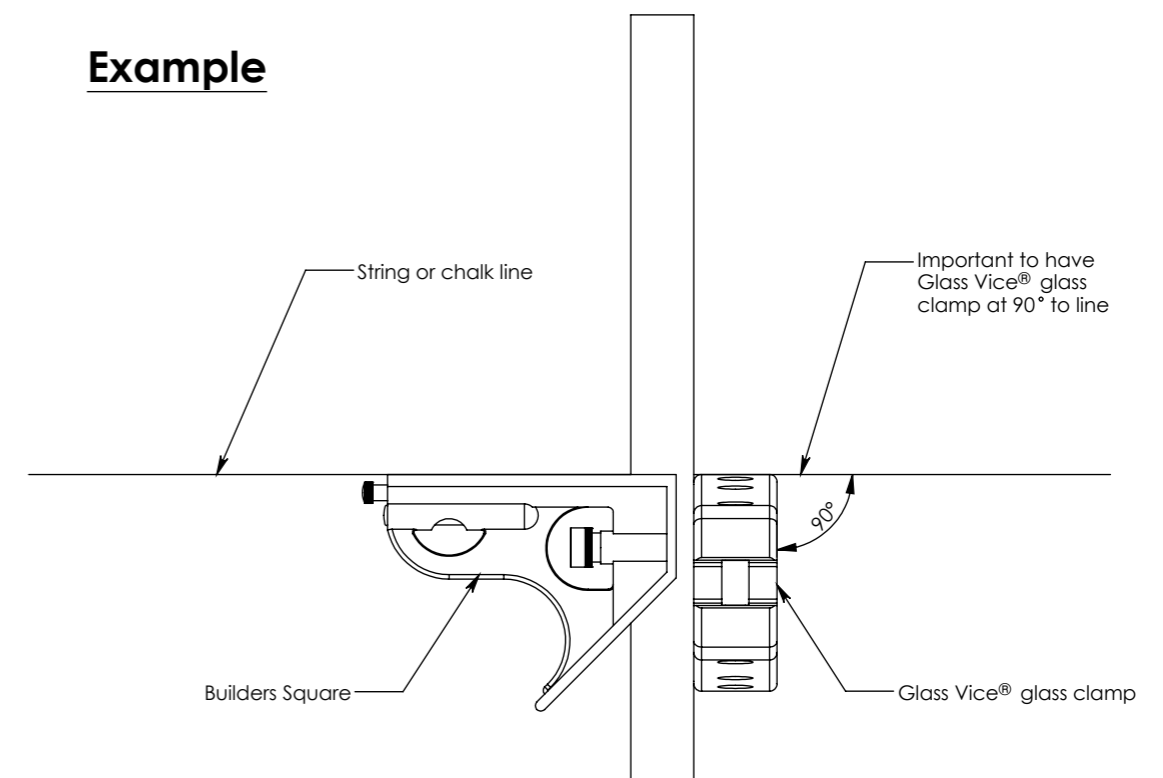

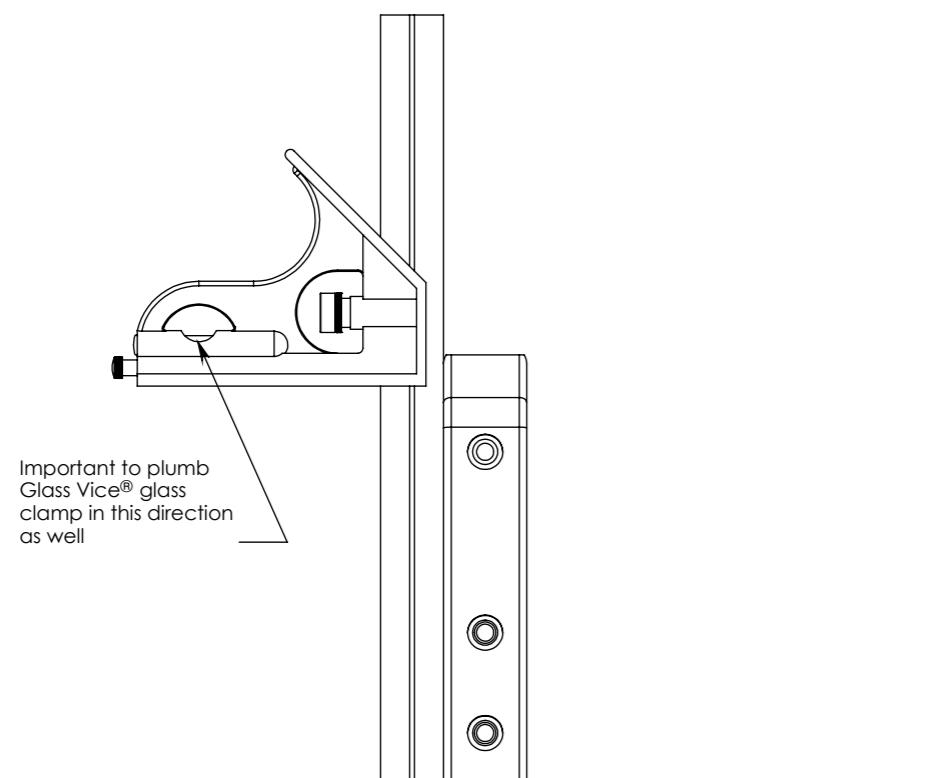
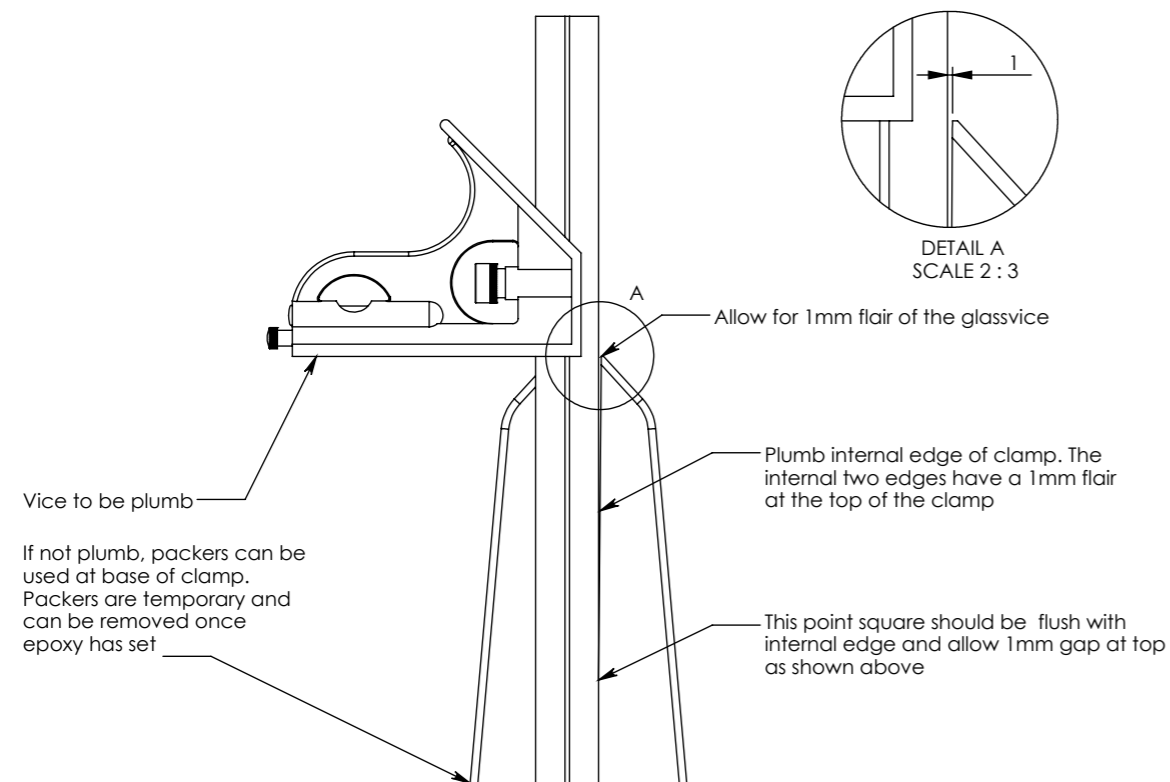

## Assembly of Adjustable Clamping System

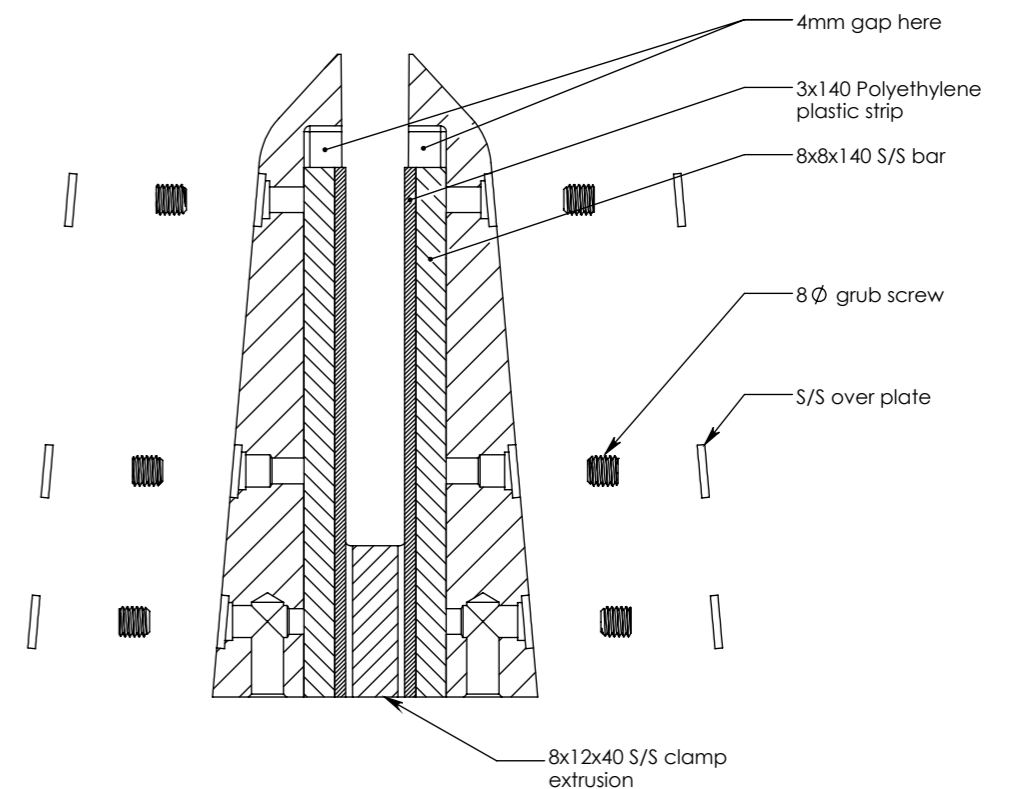

Before inserting the glass you must install the clamping system & grub screws.

- Step 1 : Insert 8x8x140mm bar into internal cavity.  
One each side  
Insert 3x140mm polyethylene strip in front of each bar.  
Finally insert the 8x12x40mm clamp extrusion into the centre bottom cavity
- Step 2 : Insert glass
- Step 3 : Using appropriate size allen key insert grub screws into each hole.  
Turn approximately 3 full turns of the allen key for each grub screw.

You are now ready to install the glass.  
Refer page 10

## To Plumb Up the Glass

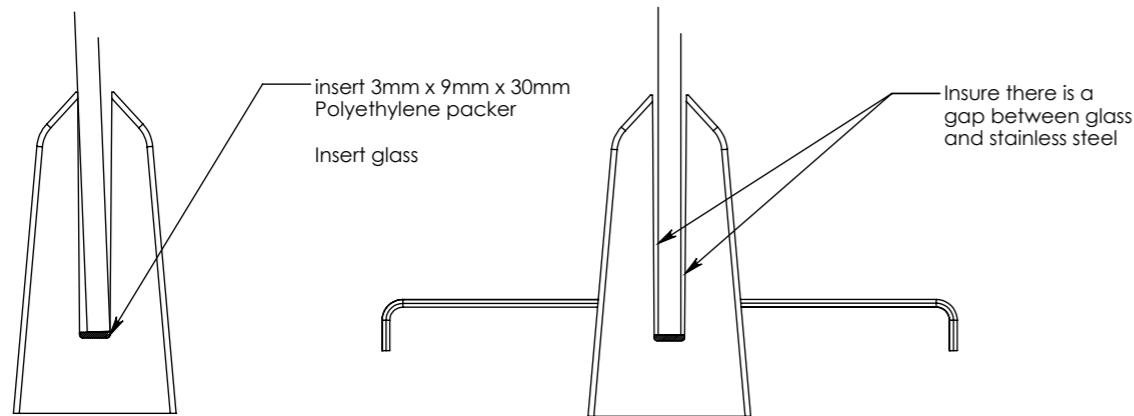

### Middle grub screw's

Start with the two middle grub screws. With a person either side wind in grub screws. The glass will become more upright. The main thing to achieve is that the glass is not touching the stainless steel clamp.

### Top two grub screws

Once this is achieved insert allenkey the other way and tighten firmly as shown above. It is important that the two people tighten at the same time.

Repeat this operation on the top two grub screws. Insert allenkey in both sides long end first. Hold a level on the glass. turn one allenkey until glass becomes plumb. Then hand tighten other grub screw.

Insert allenkeys in grub screws with short end first and hand tighten firmly at the same time.

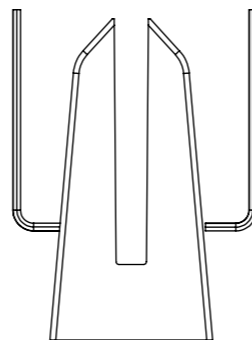

### Bottom two grub screws

Insert allenkeys into bottom two grub screws long end first.

Wind in grub screws until finger tight.

Then insert allenkeys short end first and hand tighten firmly at the same time.

## Hang a Gate

To hang a gate the hinge & latch sheets of glass must be in place and a gap of 840mm left between them.

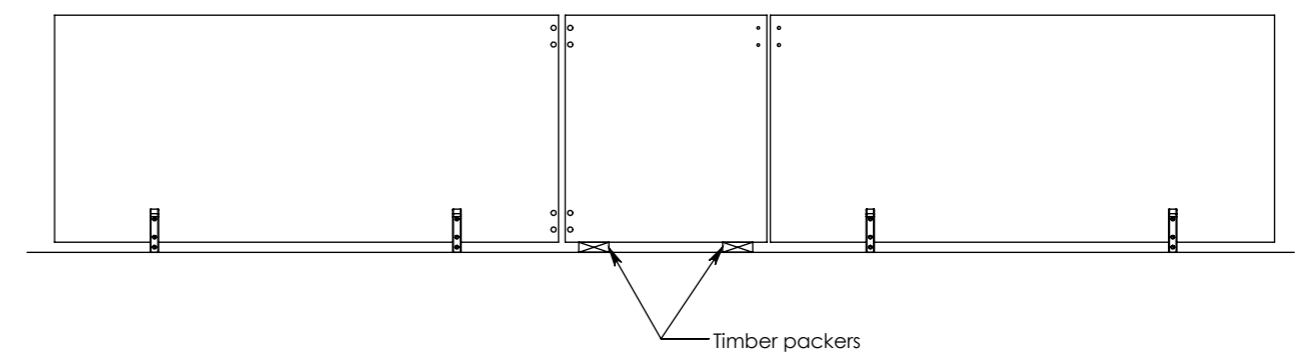
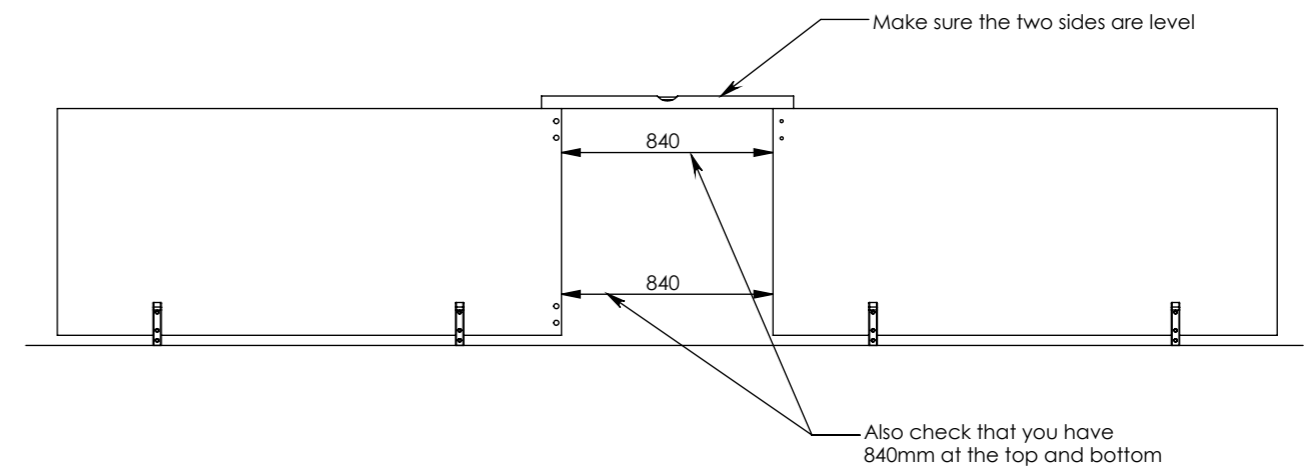

Put timber packers on ground first to the height of the bottom of the glass. Insert glass allowing 30mm for the hinge side & 10mm for the latch side

# Glass Vice® Products Ltd.

The gate must open away from swimming pool.  
Attach the hinges & latch as shown.

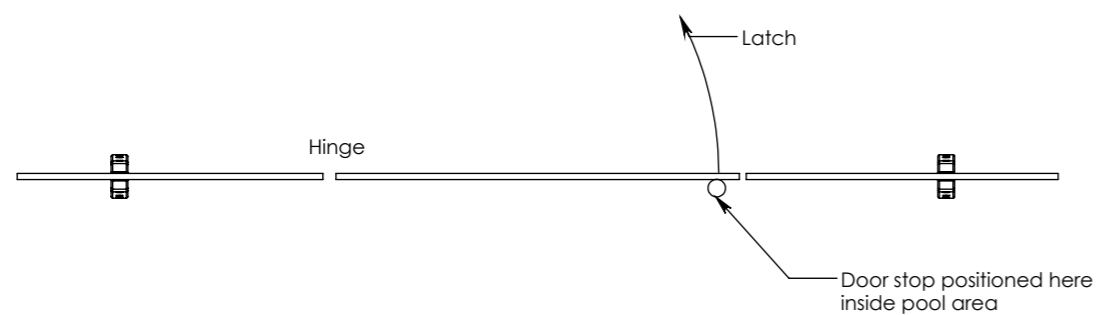
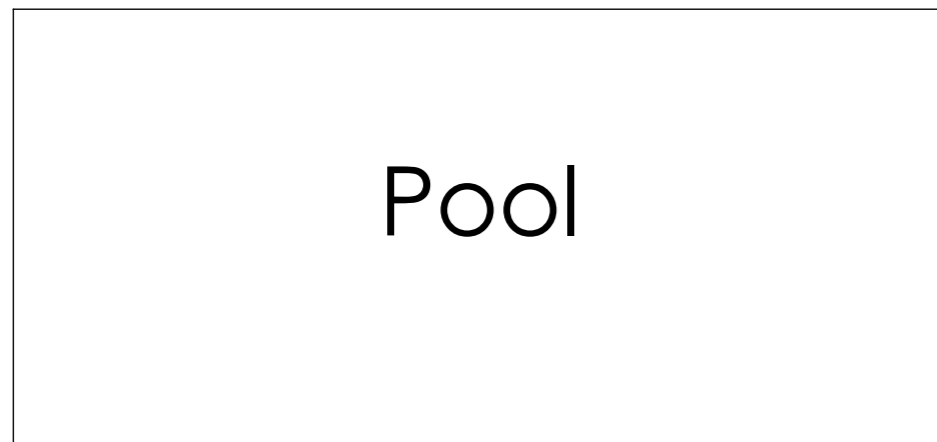
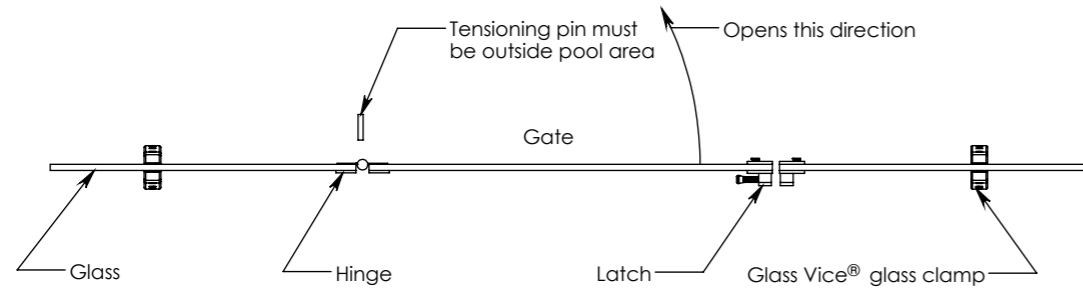

Once gate is in place & doorstop is installed tension the hinges with pin supplied. Open gate half way let it shut. Ideally it should hit the doorstop bounce back once then close.

# Glass Vice® Products Ltd.

When the latch is installed and the gate is closed the magnetic side should pull the bolt closed.

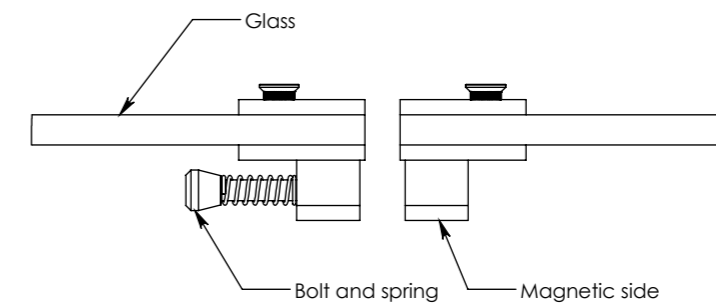

If this does not occur just cut one or two coils off the spring. It's just a case of reducing the size of the spring.



## Plumbing Up Two Or More Sheets In a Straight Line

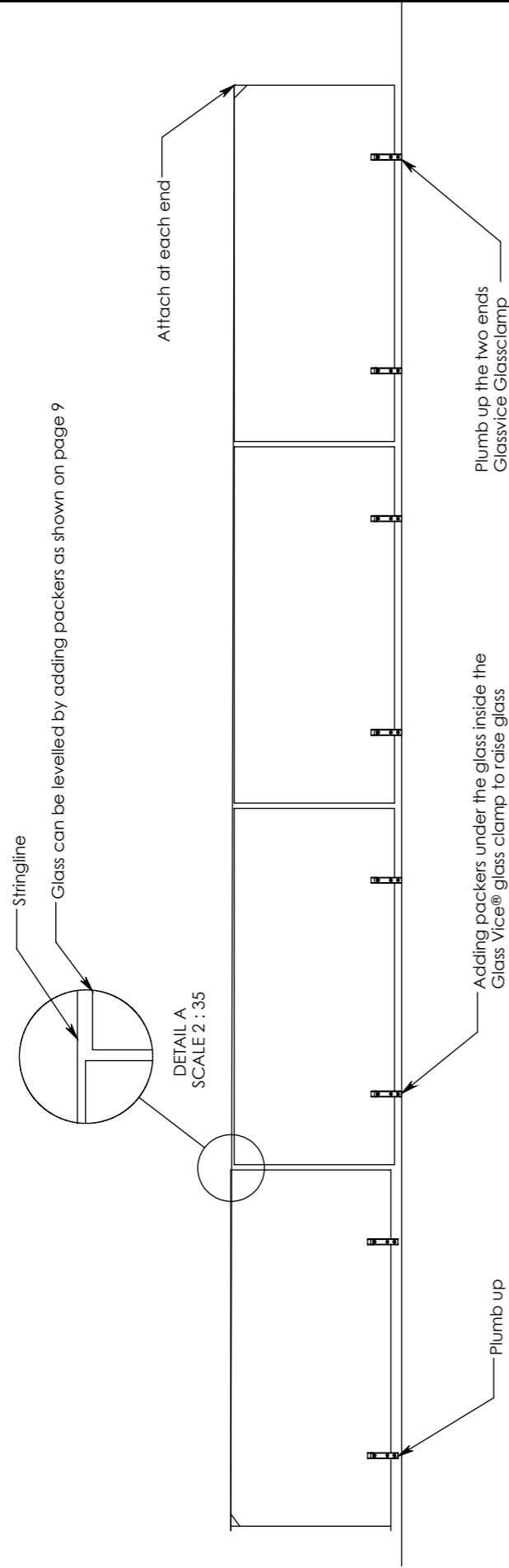

When plumbing and levelling two or more glass panels. Plumb the two outside Glass Vice® glass clamps first as shown on page 8 & 9. Attach stringline as shown in drawing. Then level the glass by adding packers as shown on page 1. Once all panels are level with the stringline then the rest of the clamps can be plumbed to the stringline as per page 7 & 8.

## Different Gate Situations

If customer wants gate hinged to house recommended setup shown below.

Figure 1

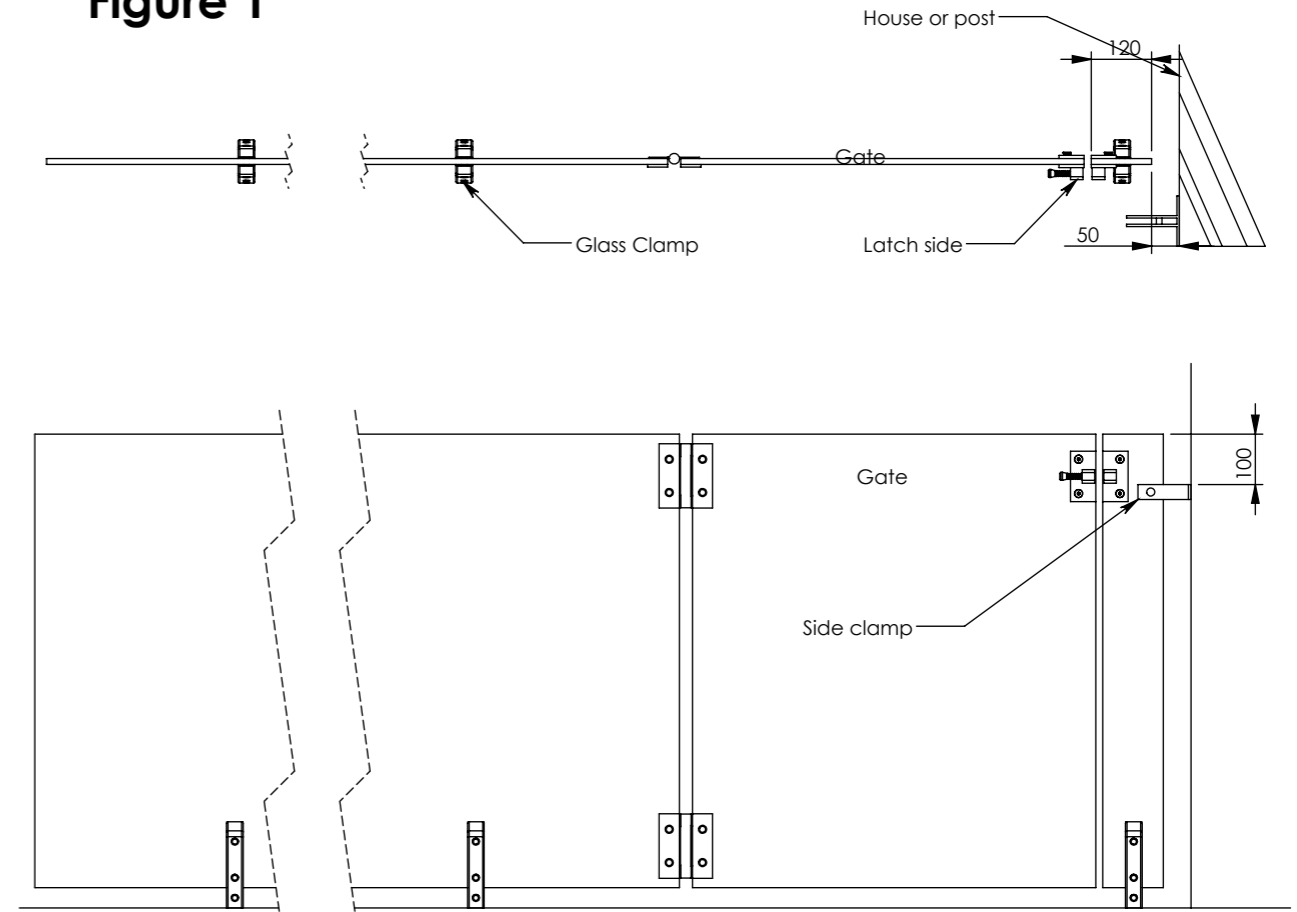

Recommend a 120mm wide piece of glass so latch can be attached to glass. Fix side clamp to support the glass panel to house or post as shown in drawing.

## If Gate is Required at the Corner of the Glass Fence

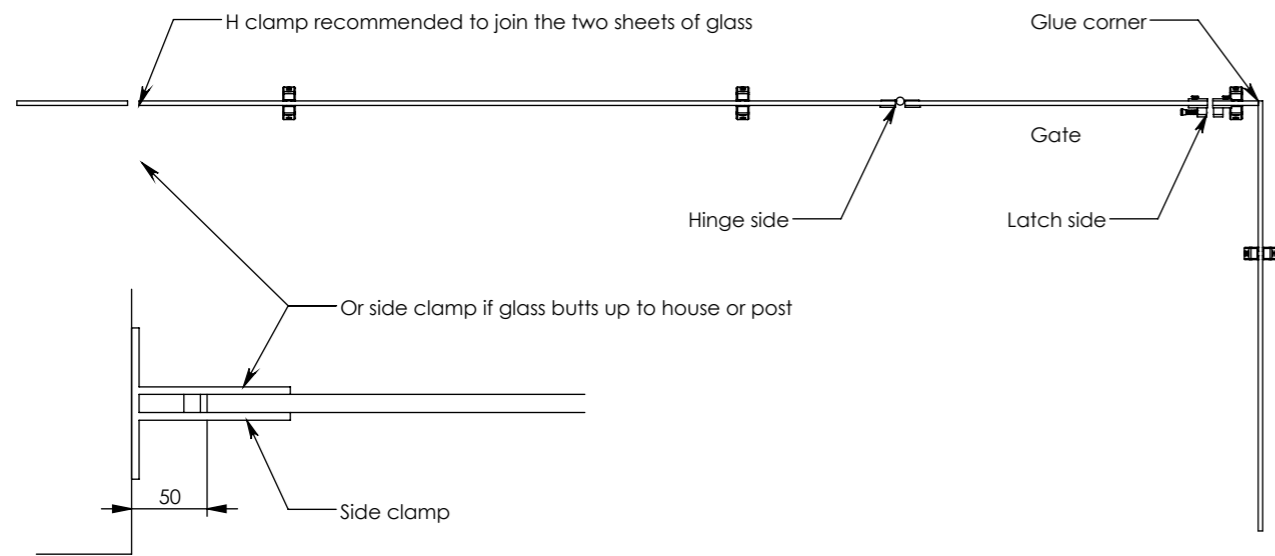

Similar to Figure 1 use a 120mm wide panel of glass for latch side & glue the latch side corner.

## Gate in the Middle of Two Large Panels

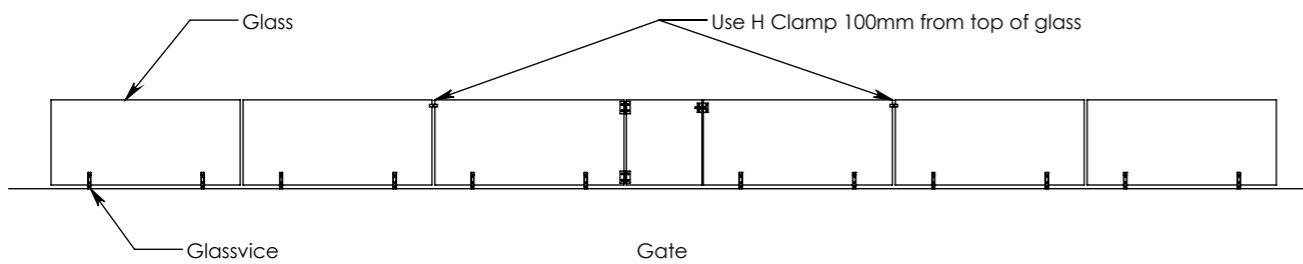

A gate suspended between two large panels of glass it is recommended to use H clamp as shown in drawings.

## Another Gate Situation

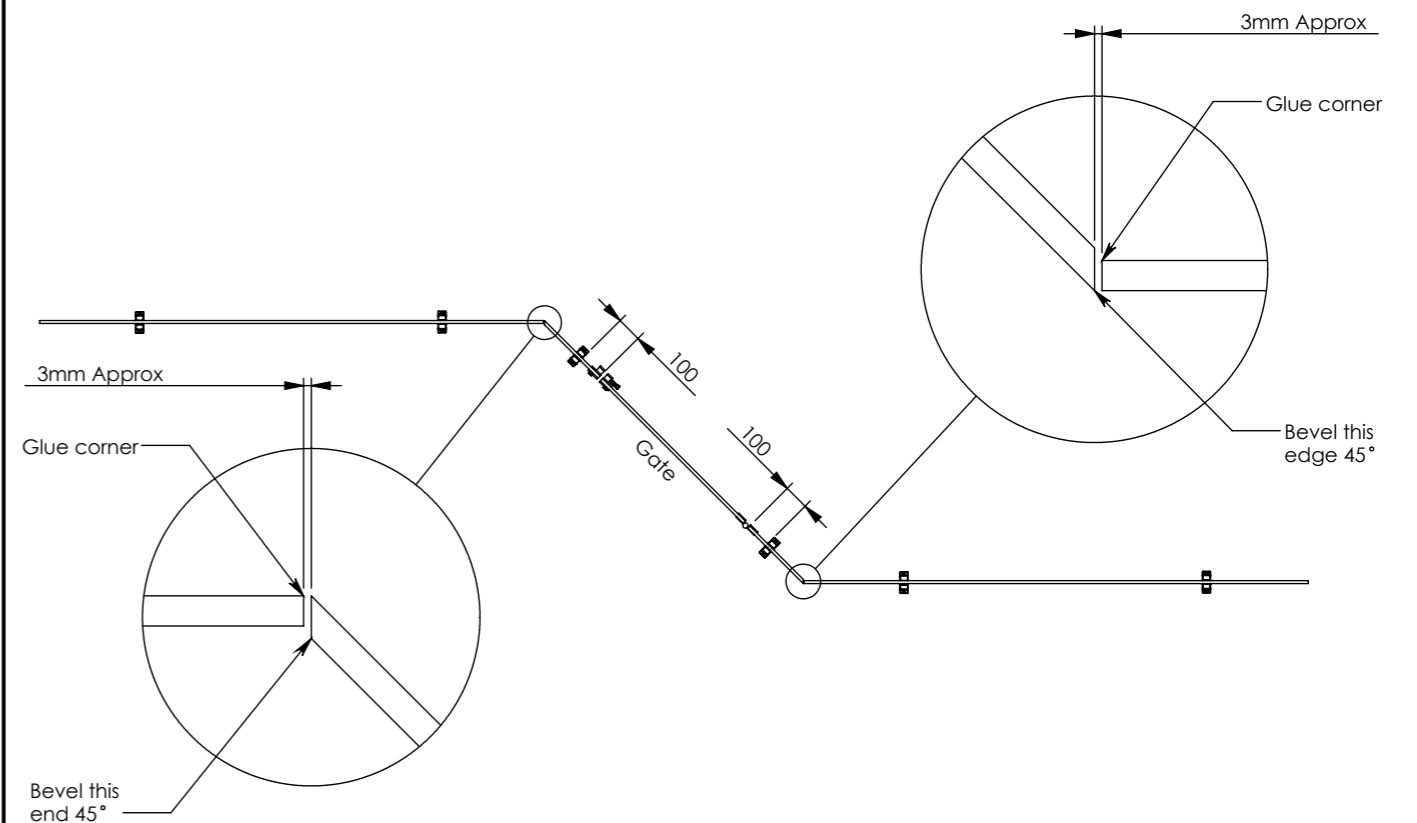

Having a gate on a 45° degree angle to the glass fence can be done. If the latch & the hinge pieces of glass are only about 400mm wide the clamps need to be fixed off centre as shown in drawing. Approx 100mm from each end & the corners are glued for strength.

## When Vices Are Fixed to An Uneven Surface

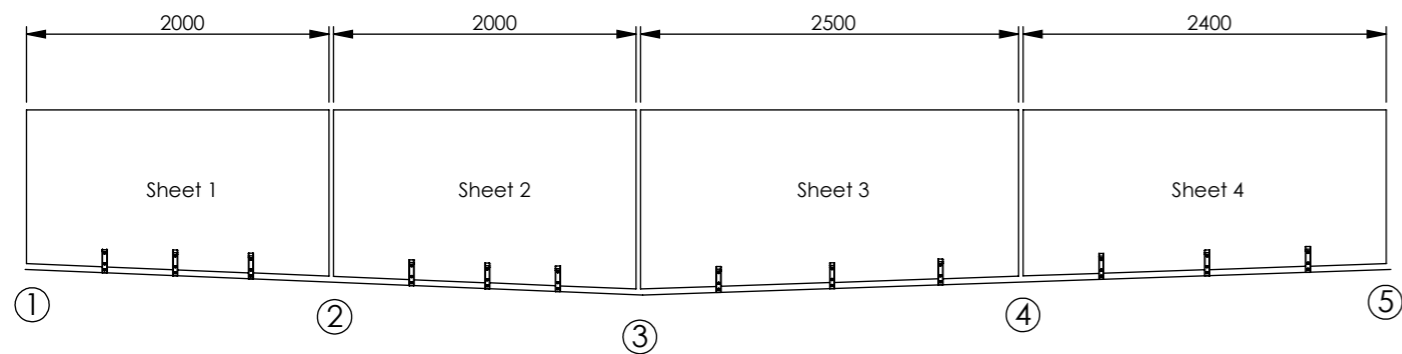

Using a Dumpy or Laser Level take a reading at points 1-5.

If 5 is the highest point, and this is a swimming pool fence 5 will be 1160 high piece of glass.

If point 4 is 15mm lower add to 1160 equals 1175 piece of glass.

If point 3 is 25mm lower add to 1160 equals 1185 piece of glass.

If 2 is 10mm lower add to 1160 equals 1170 piece of glass.

If 1 is 5mm lower add to 1160 equals 1165 piece of glass.

## The Order for This Pool Fence Glass Will be as Follows

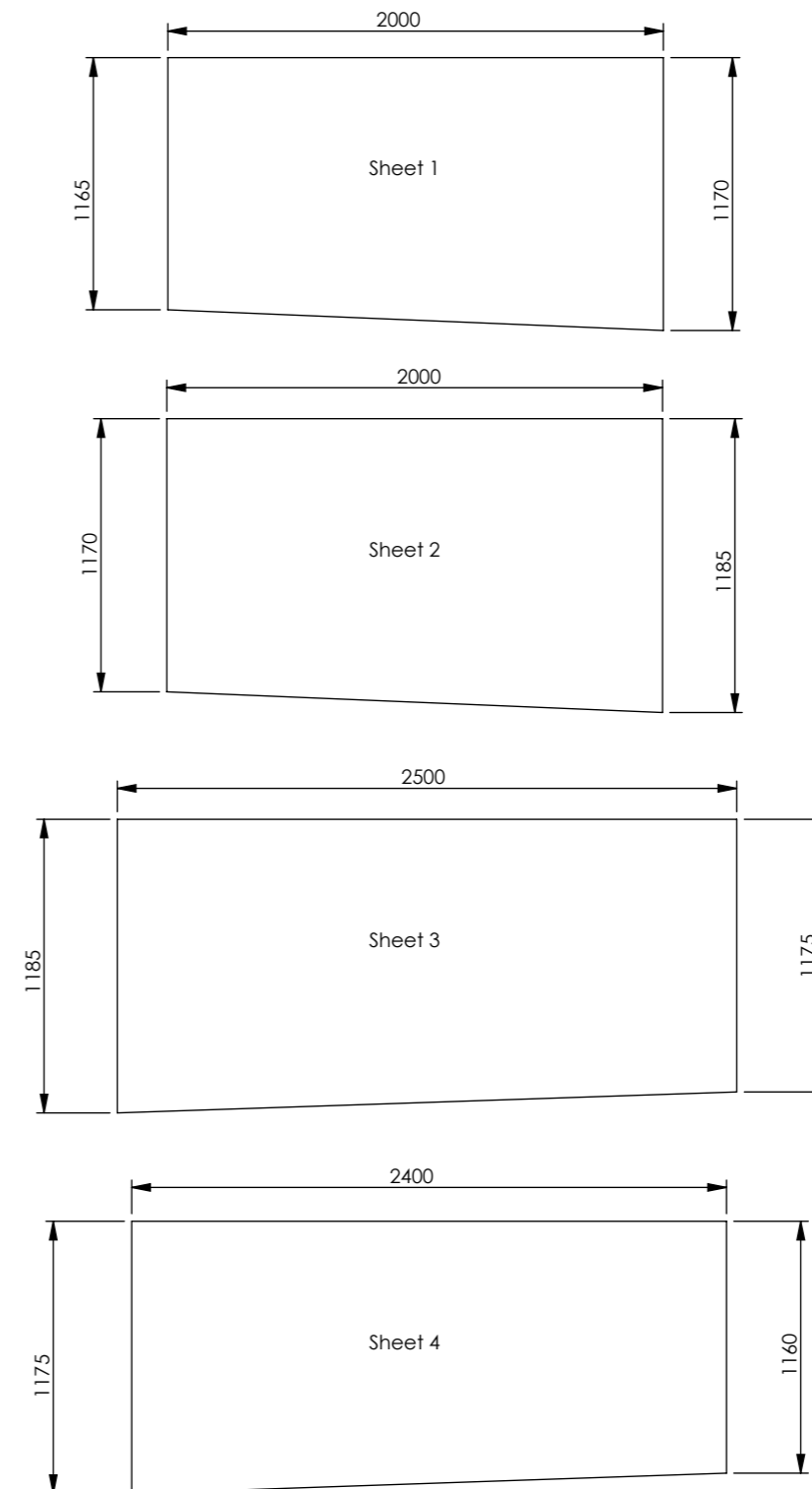

## Fixing of Architectural Bracket

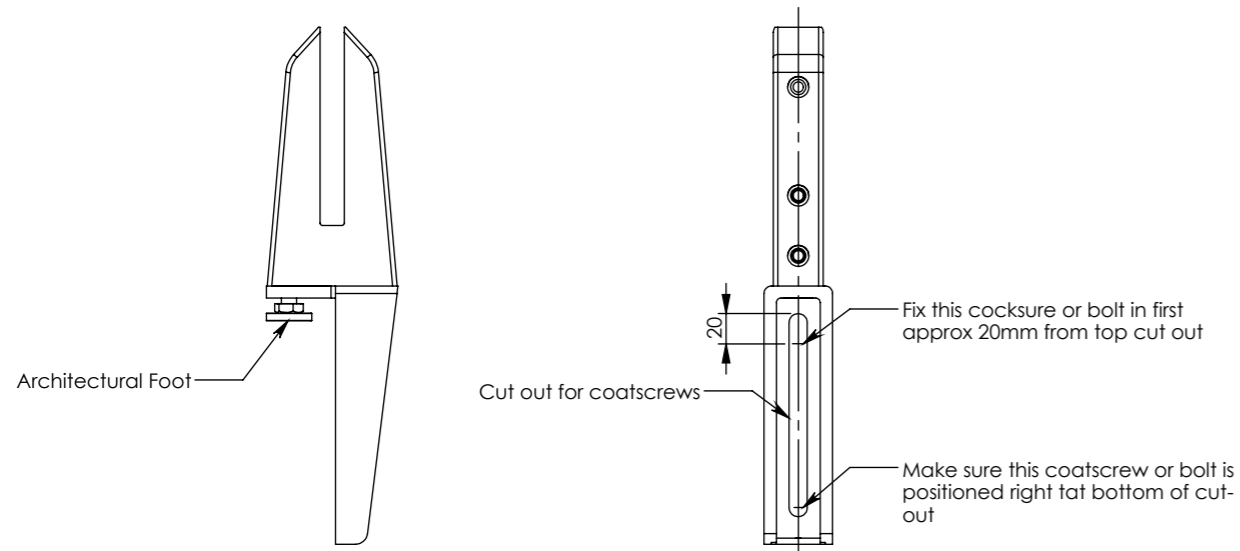

When fitting the Glass Vice® Architectural Bracket it is important to put the top lagscrew in first approx 15mm from top of cut-out. Once top lagscrew is fixed the bottom lagscrew must be positioned right at the bottom of the bracket cut-out so when the architectural foot is tightened the bracket won't just slide upwards. The tightening of the foot will tension the joist removing joist movement.

## Architectural Bracket On cavity System

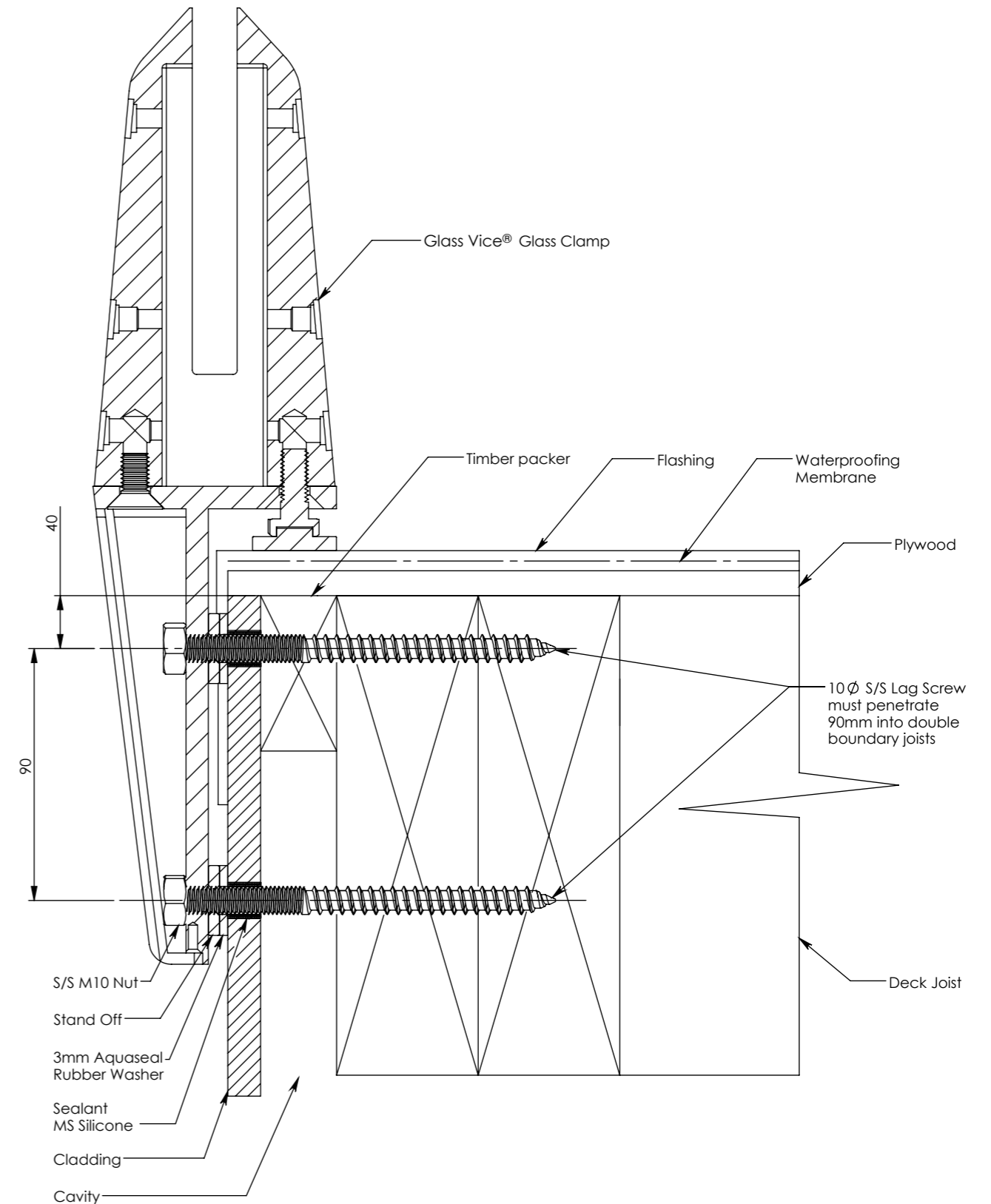

## S Bracket Detail for Decking

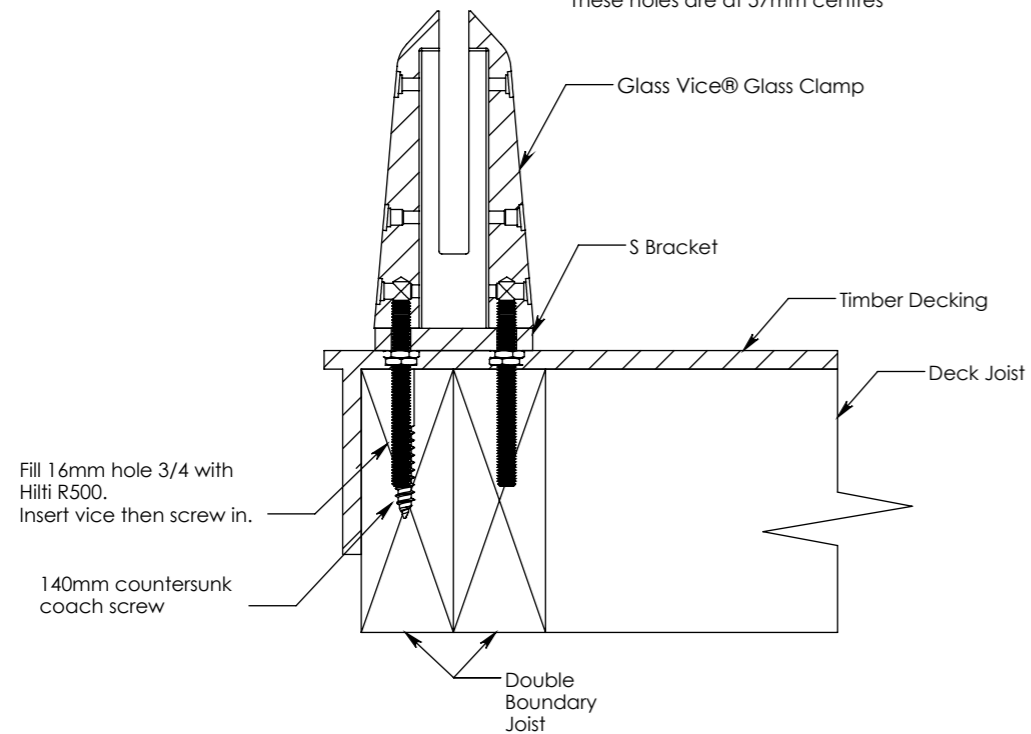
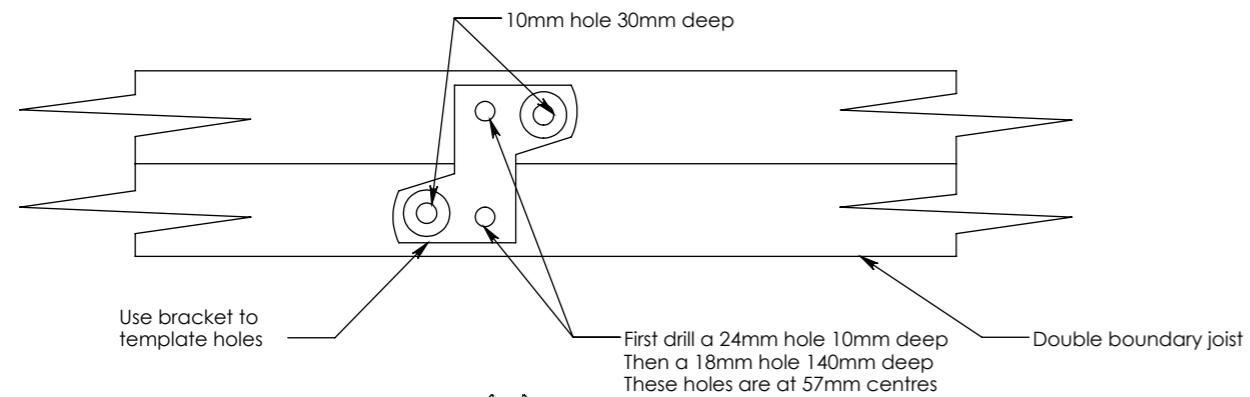
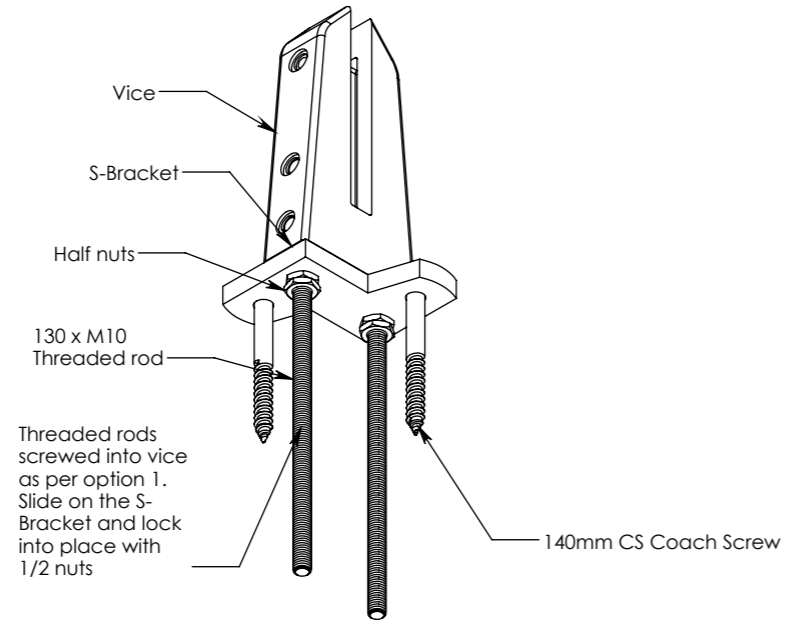

## H Clamp

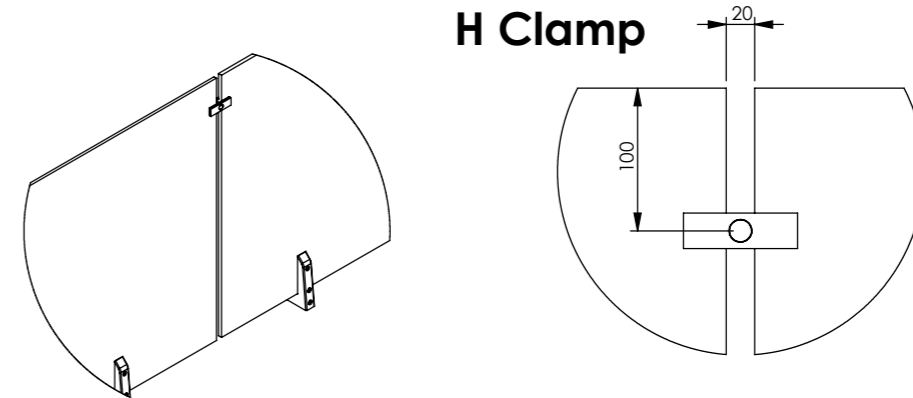

## H Clamp -Side Mounted

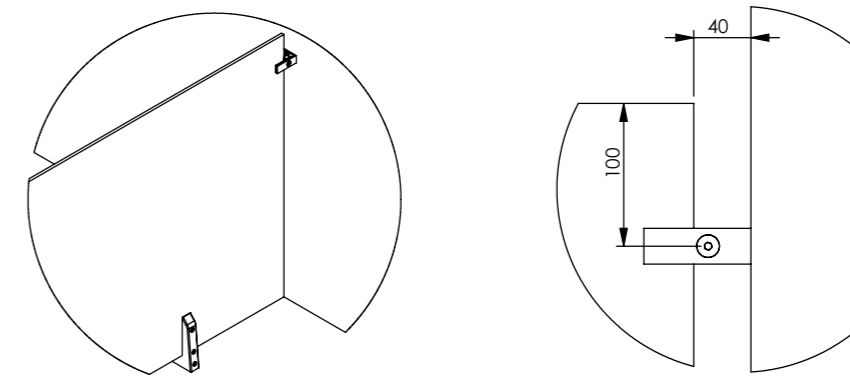

## H Clamp -2 Piece

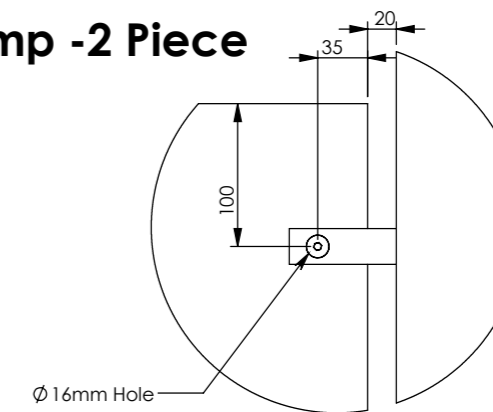

## Weatherboard H Clamp

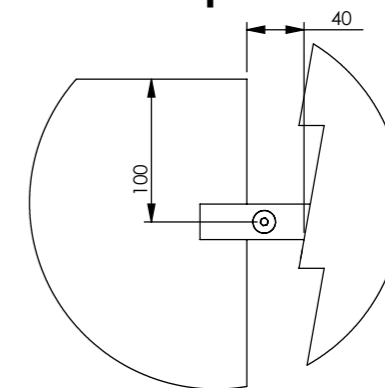

# Glass Vice® Products Ltd.

## Ballustrade Corner Clamp

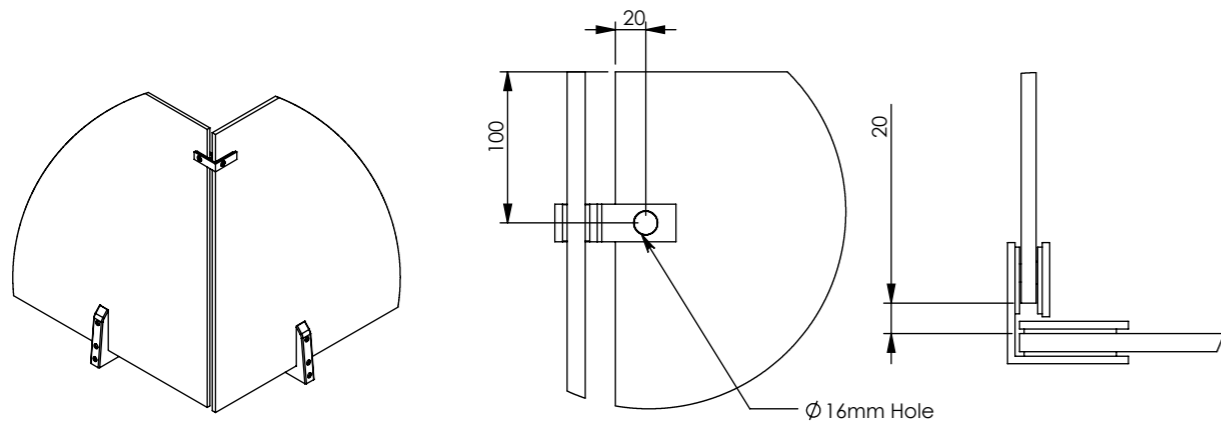

## Pool Corner Clamp

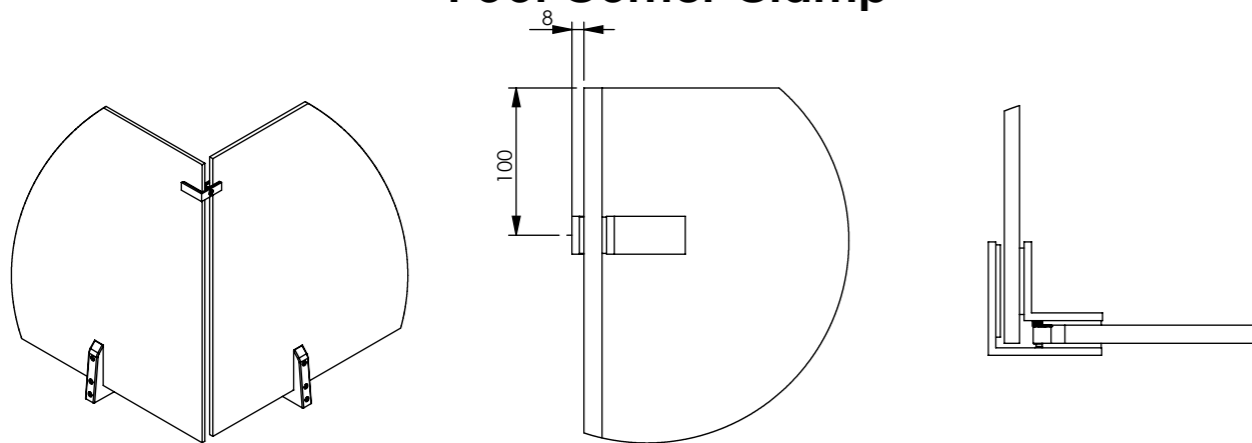

## 45 Degree H Clamp

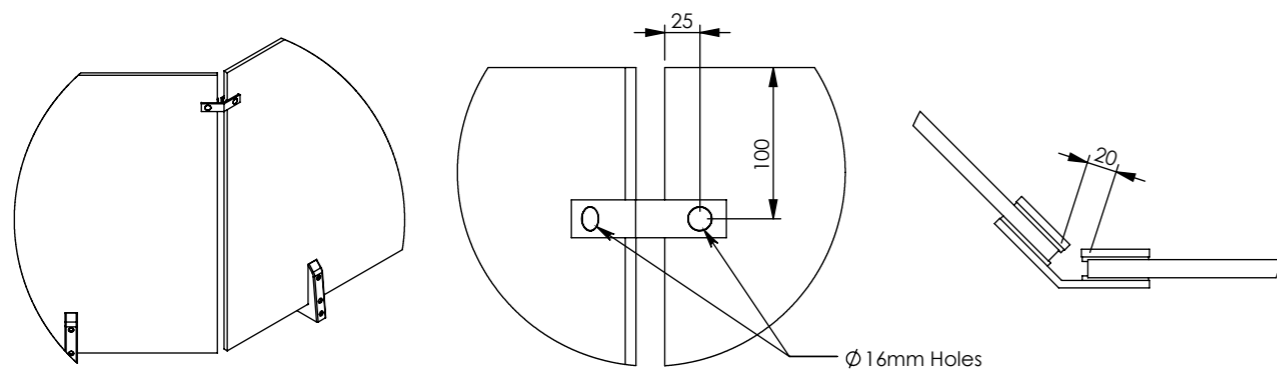

# Glass Vice® Products Ltd.

## 45 Degree H Clamp - Side Fix

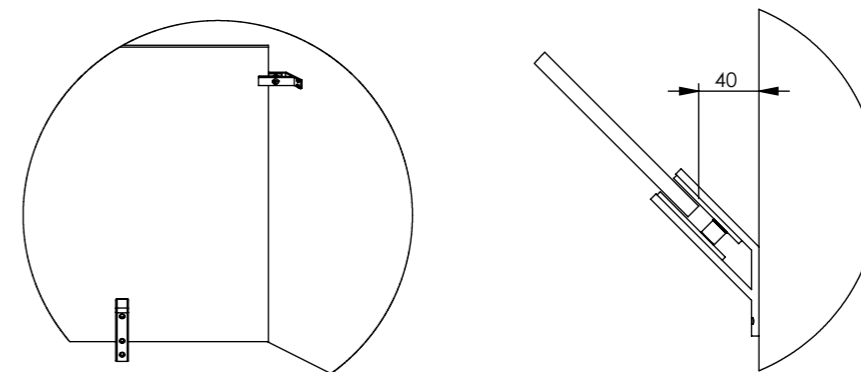

## 130 Degree H Clamp

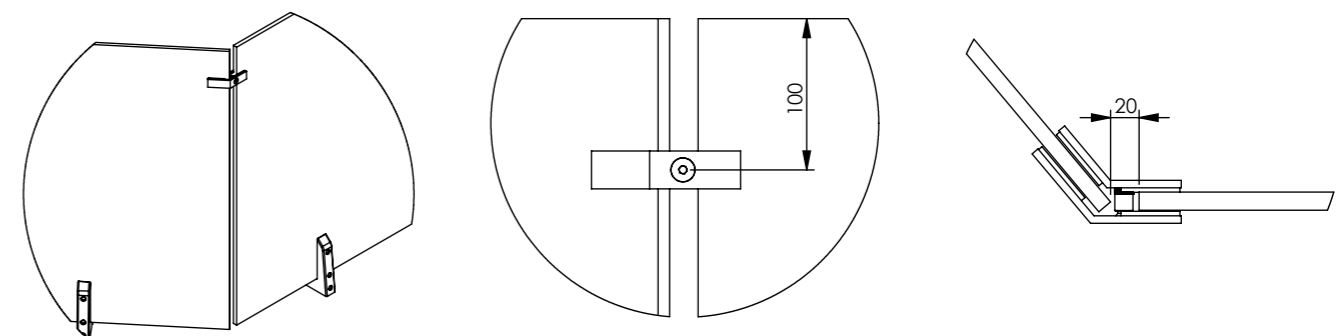

# Glass Vice® Products Ltd.

## Wedges for Balustrades

The four wedges per Glass Vice® glass clamp increase the strength of the balustrade system. There are two wedge shapes supplied, both 100mm long

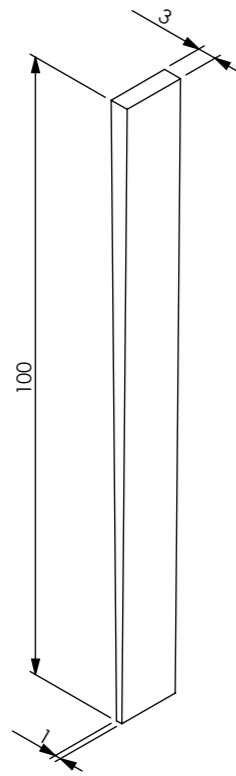

Small

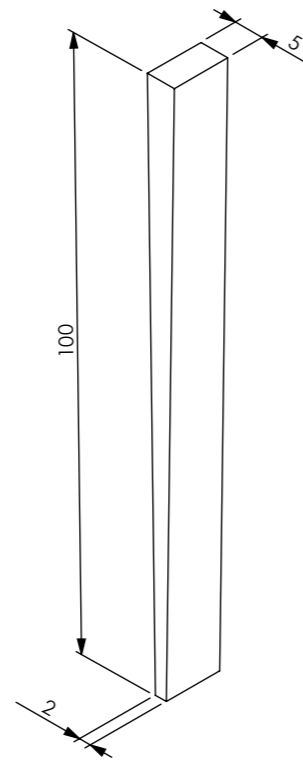

Large

Four wedges are needed per Glass Vice® glass clamp

# Glass Vice® Products Ltd.

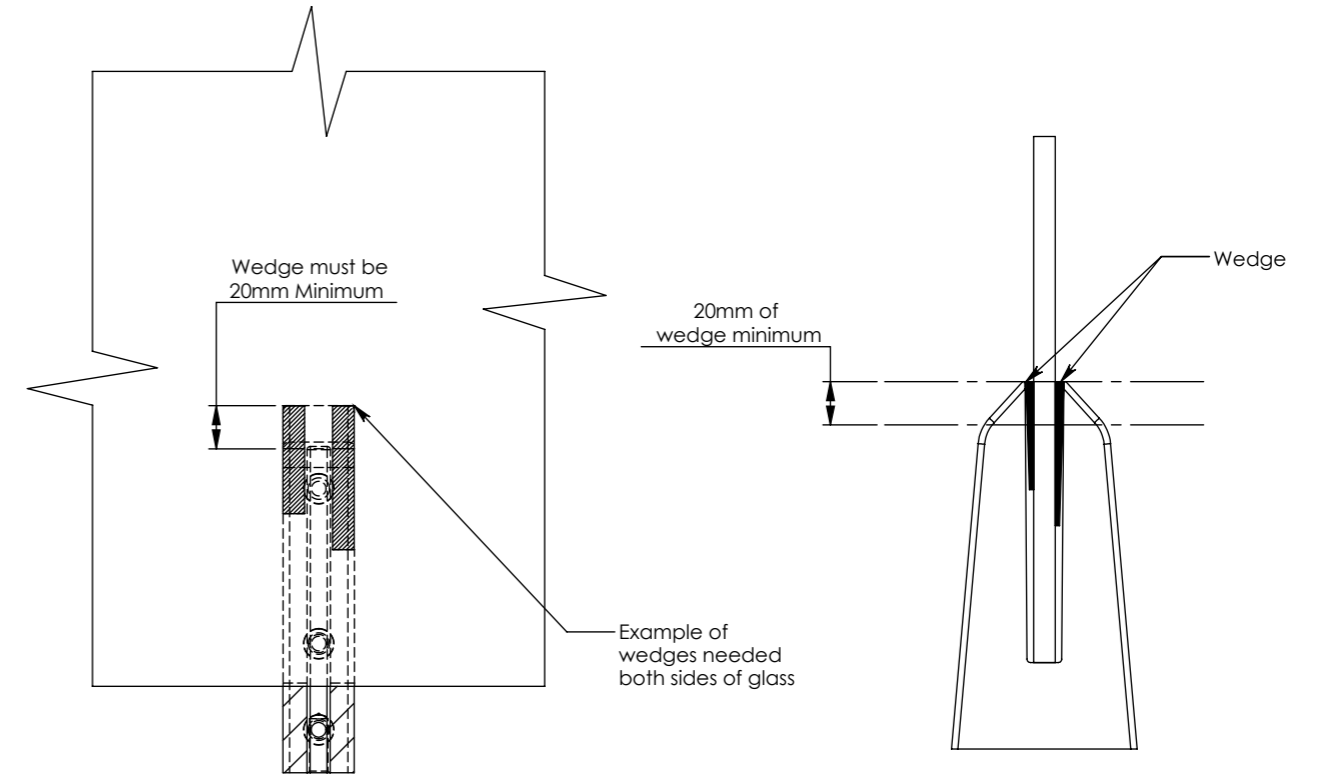

The wedges supplied are 100mm long. If you can get the whole 100mm in that's fine. But only 20mm minimum is needed.

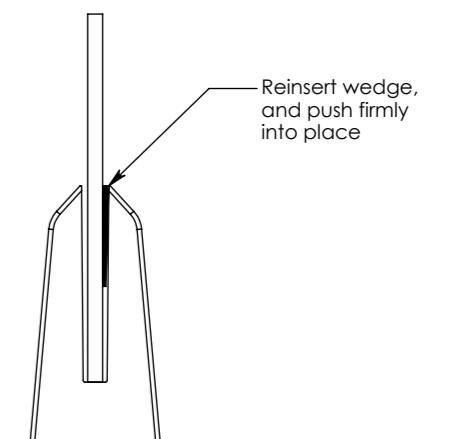
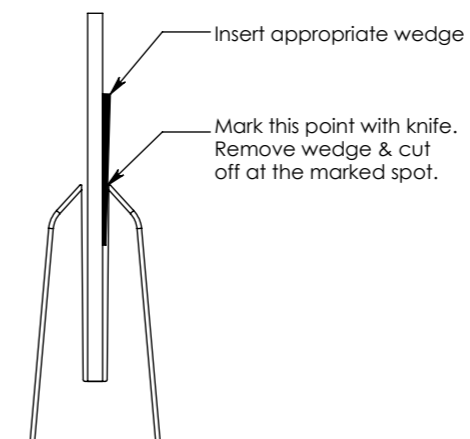

## Standard gate Detail for 12mm Toughened Safety Glass

