

BARR FENCING



Overview

BARR is a new design sensation providing the much sought after 'floating battens' look.

Panels & gates are welded and are made from 50x25mm aluminium extrusion with a sturdy 25x25mm extrusion utilised for top/bottom rails.

BARR's unique style is achieved via the 25x25mm rails passing through precision punched holes in the 50x25mm pickets – NOT face welded.

This key design feature results in a panel which is unparalleled in strength and style.

Finishes —

Genuine Akzo Nobel powder coat

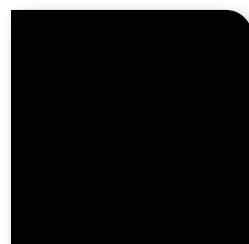

SATIN BLACK
GN150A

(B)

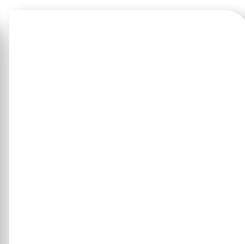

PEARL WHITE
GA078A

(W)

BARR FENCING PANELS

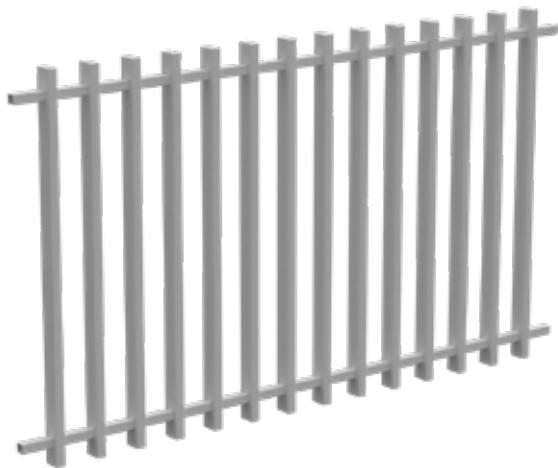

Satin black



Pearl white

TRADE TIP

Allow total bracket gap of 10 to 14mm so a 1733mm wide panel fits a daylight opening of 1743 to 1747mm

BARR 50 x 25 Panel

1000MM H x 1733MM W

Satin black (GN150A) or **pearl white** (GA078A) finish

Order Code: **BR-PANEL-1733-1000-B/W**

- 1000mm high panel; aluminium alloy 6061-T6
- 50x25mm pickets/balusters with 25mm front/facing edge
- Cap pre-inserted in the top of each picket
- Sturdy 25x25x2.8mm horizontal top/bottom rails pass through the centre of punched pickets
- Pickets welded to rails
- Panel construction is very strong with rails passing through pickets
- 50x25mm picket provides the sought after seamless 'batten' look
- Being 1000mm high, ideal for garden/perimeter fencing
- Panel easily cut down in width

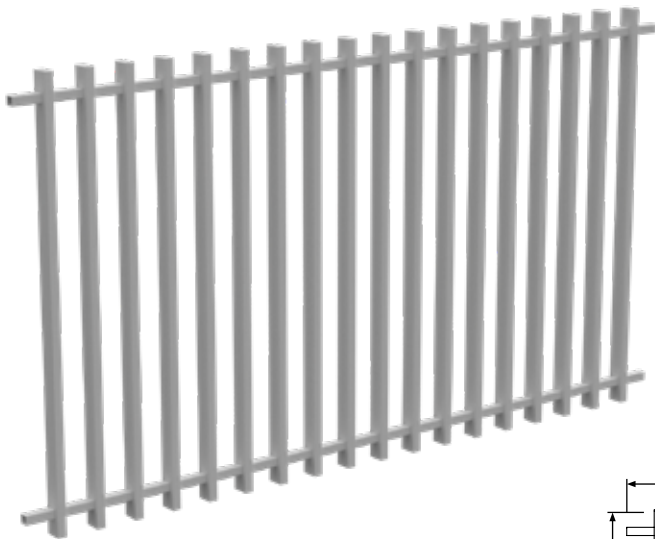
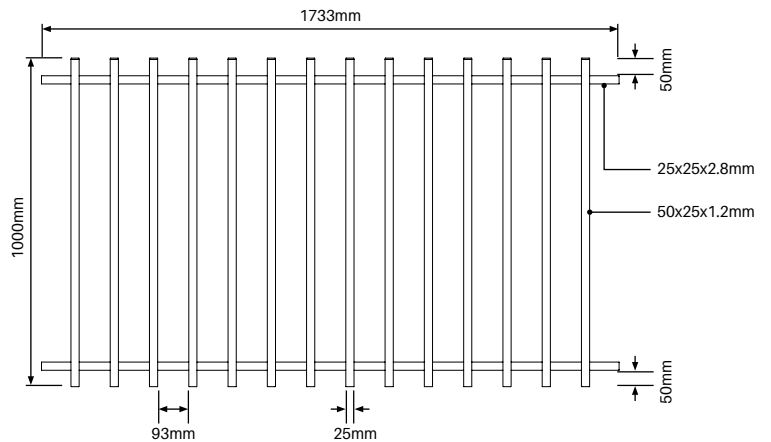

Satin black



Pearl white

TRADE TIP

Allow total bracket gap of 10 to 14mm so a 2205mm wide panel fits a daylight opening of 2215 to 2219mm

BARR 50 x 25 Panel

1200MM H x 2205MM W

Satin black (GN150A) or **pearl white** (GA078A) finish

Order Code: **BR-PANEL-2205-1200-B/W**

- Pool fencing compliant to AS 1926.1
- 1200mm high panel; aluminium alloy 6061-T6
- 50x25mm pickets/balusters with 25mm front/facing edge
- Cap pre-inserted in the top of each picket
- Sturdy 25x25x2.8mm horizontal top/bottom rails pass through the centre of punched pickets
- Pickets welded to rails
- Panel construction is very strong with rails passing through pickets
- 50x25mm picket provides the sought after seamless 'batten' look
- Panel easily cut down in width

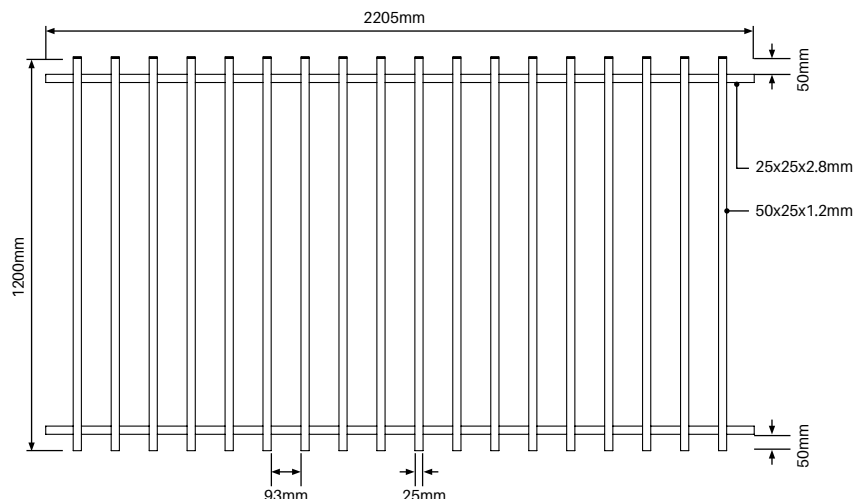

BARR FENCING PANELS

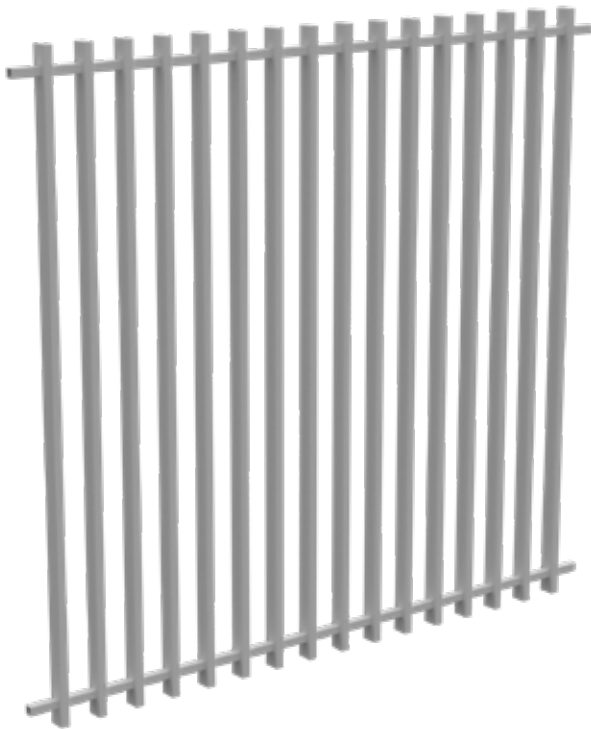

Satin black



Pearl white

TRADE TIP

Allow total bracket gap of 10 to 14mm so a 1969mm wide panel fits a daylight opening of 1979 to 1983mm

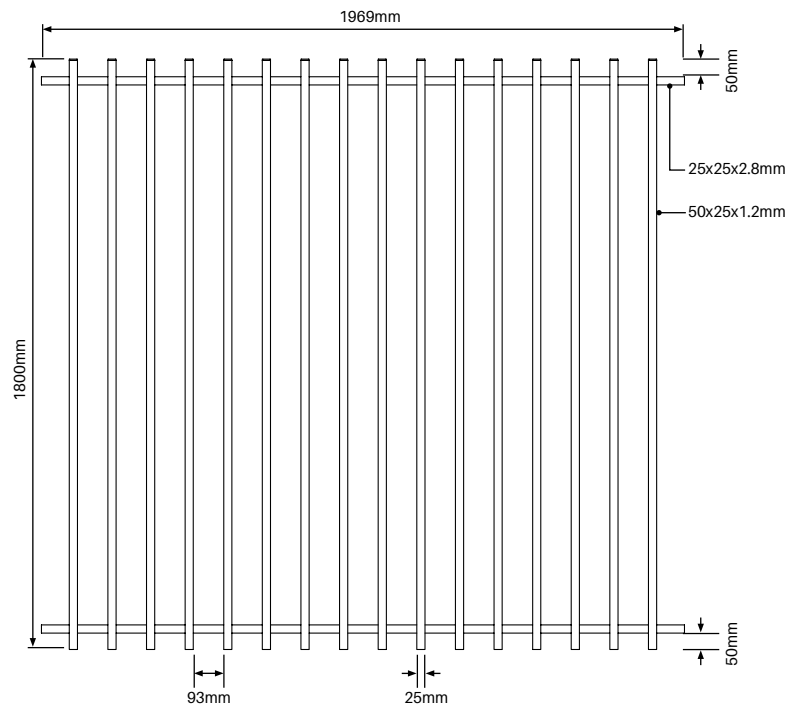

BARR 50 x 25 Panel

1800MM H x 1969MM W

Satin black (GN150A) or **pearl white** (GA078A) finish

Order Code: **BR-PANEL-1969-1800-B/W**

- Pool fencing compliant to AS 1926.1; also ideal for boundary fencing
- 1800mm high panel; aluminium alloy 6061-T6
- 50x25mm pickets/balusters with 25mm front/facing edge
- Cap pre-inserted in the top of each picket
- Sturdy 25x25x2.8mm horizontal top/bottom rails pass through the centre of punched pickets
- Pickets welded to rails
- Panel construction is very strong with rails passing through pickets
- 50x25mm picket provides the sought after seamless 'batten' look
- Panel easily cut down in width



BARR FENCING GATES

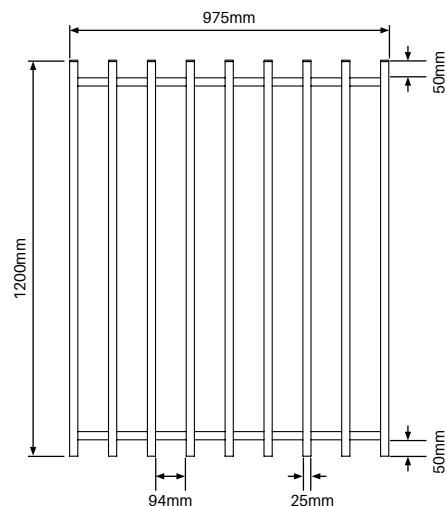

BARR 50 x 25 Gate

1200MM H x 975MM W

Satin black (GN150A) **or** **pearl white** (GA078A) **finish**

Order Code: **BR-GATE-0975-1200-B/W**

- Pool fencing compliant to AS 1926.1
- 975mm wide x 1200mm high gate
- Aluminium alloy 6061-T6
- Same construction method as panels – horizontal rails pass through 50x25mm punched pickets & welded
- Gate side stiles are also 50x25mm
- To ensure maximum strength, four sided welding of horizontal rails to vertical gate stiles
- Caps pre-inserted into pickets

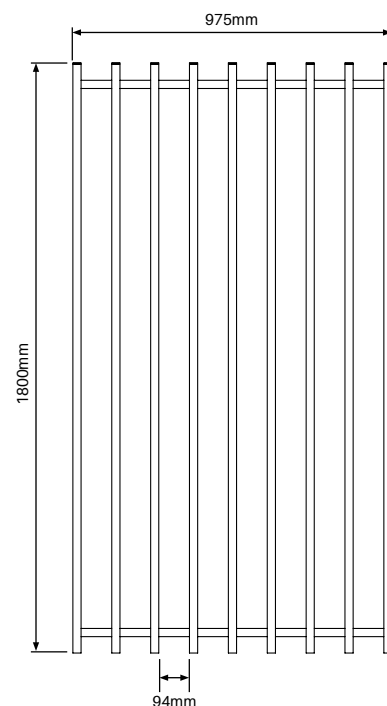
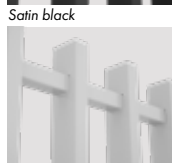
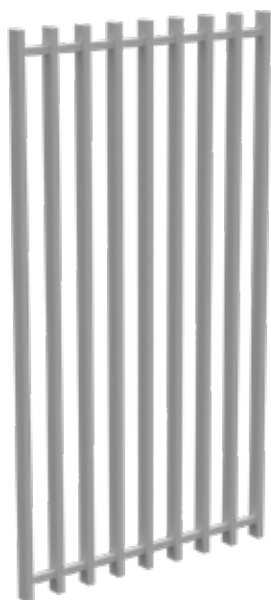

BARR 50 x 25 Gate

1800MM H x 975MM W

Satin black (GN150A) **or** **pearl white** (GA078A) **finish**

Order Code: **BR-GATE-0975-1800-B/W**

- Pool fencing compliant to AS 1926.1
- 975mm wide x 1800mm high gate
- Aluminium alloy 6061-T6
- Same construction method as panels – horizontal rails pass through 50x25mm punched pickets & welded
- Gate side stiles are also 50x25mm
- To ensure maximum strength, four sided welding of horizontal rails to gate stiles
- Caps pre-inserted into pickets

BARR FENCING POSTS



Post with welded base plate

1280mm long

Satin black or pearl white finish

Order Code: **BR-1280-BP-B/W**

- 50x25x3mm post with welded 100x75mm base plate
- Base plate is 10mm thick
- Superior rigidity with 3mm wall thickness post
- Top cap pre-inserted
- Aluminium alloy 6061-T6
- 50x25mm post profile matches pickets to give a continuous 'batten' look.
- Traditionally posts are 50x50mm which breaks up the symmetrical batten look.

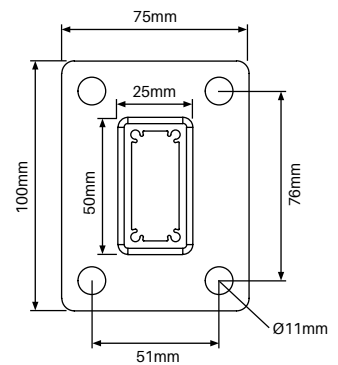

Post

1800mm long

Satin black or pearl white finish

Order Code: **BR-1800-B/W**

- 50x25x3mm post at 1800mm long
- Superior rigidity with 3mm wall thickness
- Includes top cap pre-inserted
- Includes 100mm long x 25mm wide anchor at bottom of post for aiding sturdy embedment into concrete
- Aluminium alloy 6061-T6
- 50x25mm post profile matches pickets to give a continuous 'batten' look.
- Traditionally posts are 50x50mm which breaks up the symmetrical batten look.

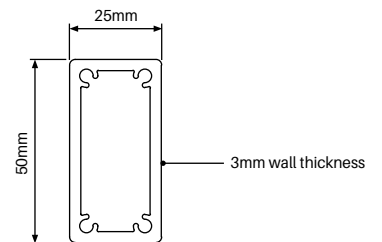

Post

2500mm long

Satin black or pearl white finish

Order Code: **BR-2500-B/W**

- 50x25x3mm post at 2500mm long
- Superior rigidity with 3mm wall thickness
- Includes top cap pre-inserted
- Includes 100mm long x 25mm wide anchor at bottom of post for aiding sturdy embedment into concrete
- Aluminium alloy 6061-T6
- 50x25mm post profile matches pickets to give a continuous 'batten' look.
- Traditionally posts are 50x50mm which breaks up the symmetrical batten look.

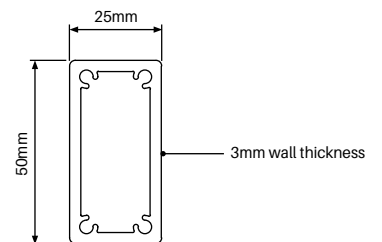

BARR FENCING ACCESSORIES

Dress ring

POWDER COATED ALUMINIUM

Satin black or pearl white finish

Order Code: **BR-DR-B/W**

- 100 x 80mm dress ring
- Suits covering a core hole up to 80mm diameter
- For BARR posts, suggested to use 63mm or 76mm core drill size

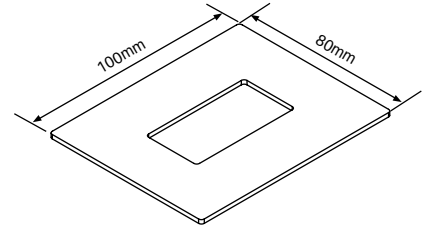
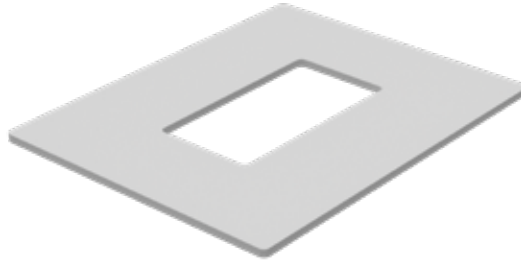

BARR 2 part domical cover

POWDER COATED ALUMINIUM

Satin black or pearl white finish

Order Code: **BR-DC-2P-B/W**

- Suits BARR base plated posts
- 107 x 72mm outer; 52 x 27mm inner
- 30mm high
- Features epoxy primer base coat prior to power coating for enhanced durability
- Innovative 2 part design allows for fitting after post/fence installation

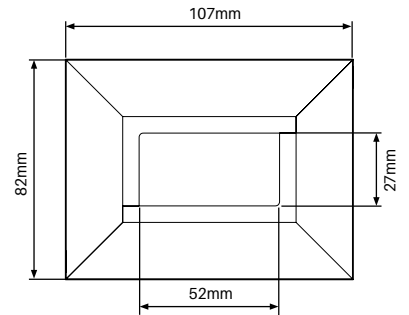

M10 Timber fixing kit

4 PACK – SS316

Order Code: **S-110LAG-4PK**

- M10 x 110mm timber lag screws x4 with nuts and washers
- Pack of 4
- Use for base plate fixing



M10 Concrete fixing kit

4 PACK – SS316

Order Code: **S-120ROD-4PK**

- M10 x 120mm concrete threaded rods x4 with nuts and washers
- Pack of 4
- Use for base plate fixing



M10 dome nut

PACK OF 4 – SS316

Order Code: **S-M10DN-4PK**

- 4 x dome nuts & split washers
- Suits M10 thread

Tip: if M10 fixing kit used, discard standard nuts from kit and replace with dome nuts

BARR FENCING POSTS

Mid face mount post

1500mm H

Satin Black or Pearl White finish

Order Code: **AR-1500-FMID-B (Black)**

AR-1500-FMID-W (White)

- 1500mm long face mount MID post
- Heavy duty 50x50mm aluminium profile: 4mm wall post thickness
- 150x150mm welded on plate: 10mm thick
- 4 x 13mm diameter fixing holes
- Easily cut down height of post to required length
- Aluminium top plate included with post (top plates available separately if required (order code: XP-TP-B (black); XP-TP-W (white))

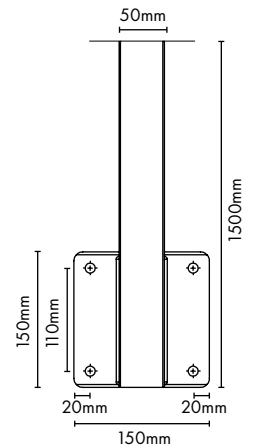
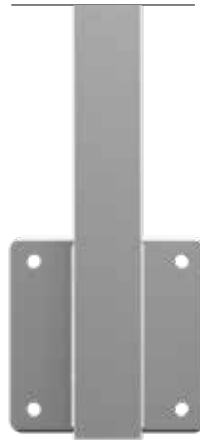

FINISHES

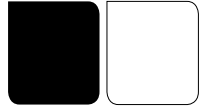

BLACK

WHITE



STEP 1

Install anchors ensuring alignment to post plate holes



STEP 2

Fix off with dome nuts if using threaded rod or lag screw anchors



STEP 3

Install BARR panels & brackets



STEP 4

Finished installation

Face mount – 1 left & 1 right

1500mm H

Satin Black or Pearl White finish

Order Code: **AR-1500-FMLR-B-2PK (Black)**

AR-1500-FMLR-W-2PK (White)

- 1500mm long face mount END posts - LEFT & RIGHT
- Heavy duty 50x50mm aluminium profile: 4mm wall post thickness
- 160mmWx150Hmm welded on offset plates: 10mm thick
- 4 x 13mm diameter fixing holes
- Easily cut down height of post to required length
- Offset plates enable posts to be positioned at absolute ends of face mount installations
- Aluminium top plate included with post (top plates available separately if required (order code: XP-TP-B (black); XP-TP-W (white))
- Sold as a 2 pack (left & right)

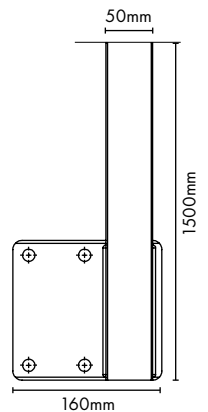
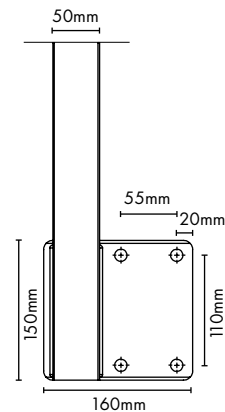

FINISHES



BLACK

WHITE

BARR FENCING ACCESSORIES

M12 dome nut

PACK OF 4 – SS316

Black or Silver finish

Order Code: **GS-DN-4PK-B (Black)**

GS-DN-4PK (Silver)

- 4x dome nuts & 4x split washers
- Suits M12 thread

Silver recommended for white powder coat installations. Black recommended for black powder coat installations.

IMPORTANT NOTE: M12 fixings suits 13mm hole diameter in FACE MOUNTED posts. Cannot be used for fixing of base plated posts (which have 11mm diameter holes in base plates).



FINISHES



MATT BLACK SILVER

M 12 FIXINGS

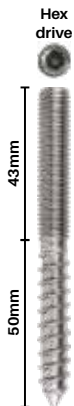

93mm lag screw

SS304

M12 thread

Order Code: **GS093LAG**

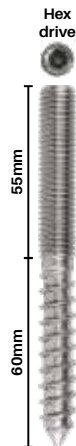

115mm lag screw

SS304

M12 thread

Order Code: **GS115LAG**

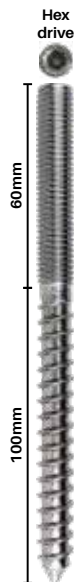

160mm lag screw

SS304

M12 thread

Order Code: **GS160LAG**

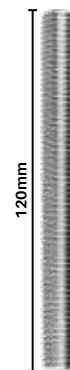

120mm threaded rod

SS304

M12 thread

Order Code: **GS120ROD**

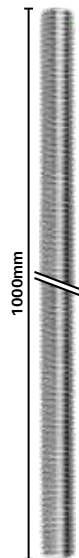

1000mm threaded rod

SS304

M12 thread

Order Code: **GS1000ROD**

Soudafix CA1400 Chemical anchor

280mL

Order Code: **SOUD-CA1400**

- High performance, two-component chemical anchoring resin for the pressure-free securing of anchoring rods, studs, threaded collars etc
- Easy to use and apply
- Fast cure (20°C=45min full cure; 30°C=25min full cure)
- Vinyl ester styrene free
- Can be used in damp concrete
- Apply with standard caulking gun



BARR FENCING ACCESSORIES

BARR Top Cap

50 x 25 x 4MM

Satin black or pearl white finish

Order Code: BR-TCA-B/W

- Optional extra 4mm thick aluminium powder coated top cap
- Presses into screw flutes in 50x25mm pickets and/or posts
- Panels and posts come with nylon caps preinserted. Option to remove and replace with aluminium caps
- Made from solid aluminium and CNC machined (not die cast aluminium)

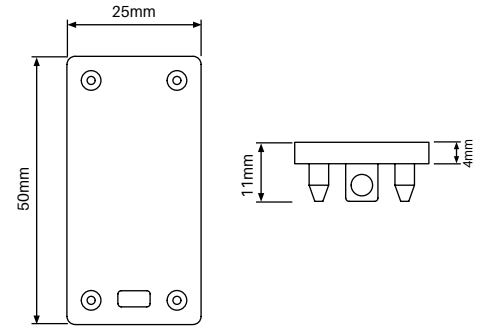
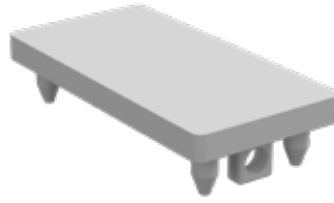

BARR 'C' Bracket Kit

4 PACK

Satin black or pearl white finish

Order Code: BR-BR25-B/W-4PK

- Slimline "C" bracket for neat fixing of panels to posts/wall
- Made from extruded aluminium
- A stylish solution versus traditional full shrouds
- Sold as a pack of 4 x "C" brackets with matching screws
- Screws supplied for each bracket include 1 x countersunk SS304 screw for fixing to aluminium posts & 2 x panhead SS304 square drive screws for fixing the panels to the rails

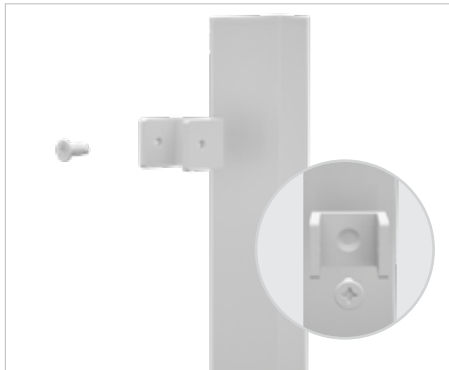
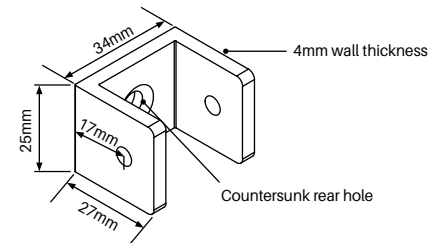
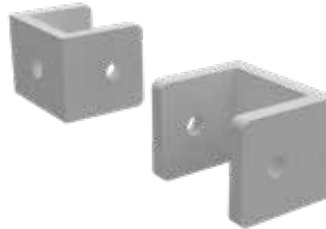

- 1** Fix C bracket to post/wall using countersunk fixing. Fixing is hidden and is flush with back of bracket.



- 2** Insert panel into C bracket opening and pilot hole drill horizontal rails on both sides.



- 3** Fix off both sides with panhead screws. Screw heads are colour matched.

BARR Extended 'C' Bracket Kit

4 PACK

Satin black or pearl white finish

Order Code: BR-BR60-B/W-4PK

- EXTENDED "C" bracket for neat fixing of panels to posts/wall
- Made from extruded aluminium
- Sold as a pack of 4 x EXTENDED "C" brackets with matching screws
- Features a longer back leg allowing 2 x fixings to post/wall for extra strength if needed
- Screws supplied for each bracket include 2 x countersunk SS304 screw for fixing to aluminium posts & 2 x panhead SS304 square drive screws for fixing the panels with the rails

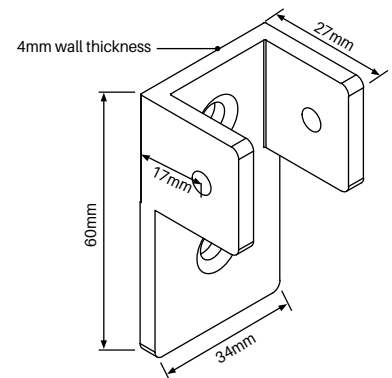
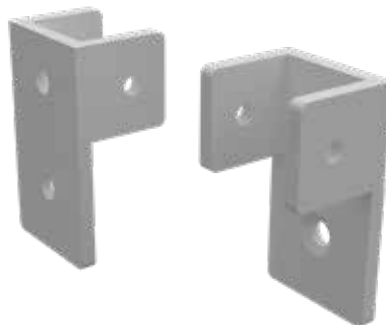

BARR FENCING ACCESSORIES

Bracket cap

34MM W x 25MM L

4 PACK

Black or White finish

Order Code: **BR-BRCAP-B-4PK (Black)**
BR-BRCAP-W-4PK (White)

- Optional extra cap
- Covers gap between horizontal rail end and "C" bracket
- Made from nylon available in white or black
- Pack of 4 suits 1 x BARR panel

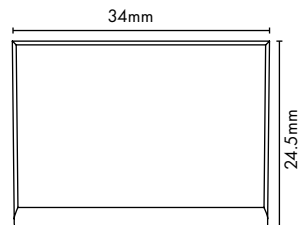
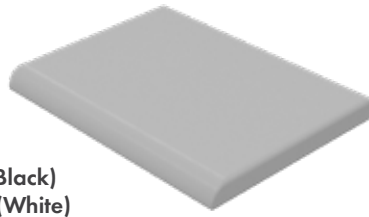

AFTER BARR PANEL IS INSTALLED

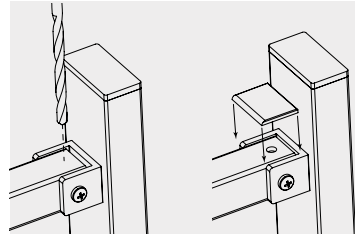

2 X TOP BRACKETS

Drill 6mm hole 15mm from post into 25x25mm horizontal rail. Push cap with lug into hole.

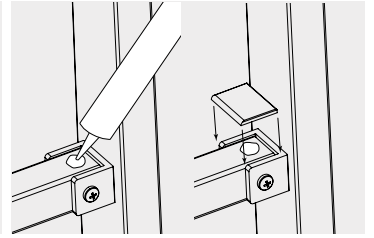

2 X BOTTOM BRACKETS

Apply structural silicone to rail and press on cap without lug ensuring excess silicone is removed.



BARR FENCING GATE CONVERTERS



BARR gate converter

1000/1200/1800mm high
Satin black or pearl white finish

Order Code: **BR-1000-GC-2PK-B**

BR-1000-GC-2PK-W

BR-1200-GC-2PK-B

BR-1200-GC-2PK-W

BR-1800-GC-2PK-B

BR-1800-GC-2PK-W

- Easily convert standard BARR panels into pedestrian gates
- Available to suit 1000, 1200 & 1800mm high panels
- Simply adjust panel to required width, place converters both sides and fix off
- Bolt/nuts are included and are colour matched
- Gate converter stiles are 50x25mm profile to match standard pickets
- Top caps included
- Sold as a pair (for left & right side of gate)

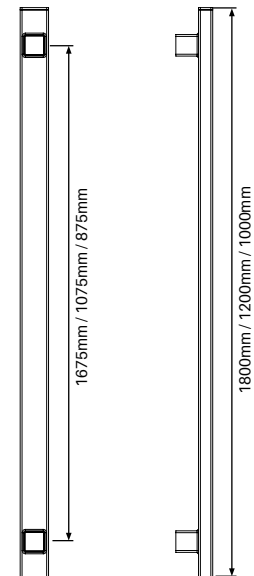

- 1** Cut panel to required width.
NOTE: ensure minimum of 42mm of horizontal rail remains both sides past pickets for attaching of converters

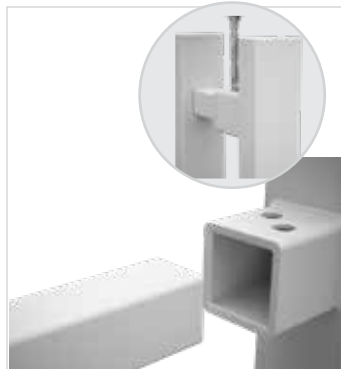

- 2** Insert panel ends into converter and drill through guide holes.



- 3** Fix off converters both sides with nut/bolts provided.



- 4** Completed gate.

Horseshoe Packers

20 PACK

Black finish

Order Code: **HSP-75X38-1MM-20PK**

1mm thick

HSP-75X38-3MM-20PK

3mm thick

- 38mm wide x 75mm long horseshoe packers
- 10.5mm slot
- Available in 1mm or 3mm thick (20 per pack)
- Durable black solid polypropylene
- Handy for levelling adjustments while installing
- Easy to cut down to required length

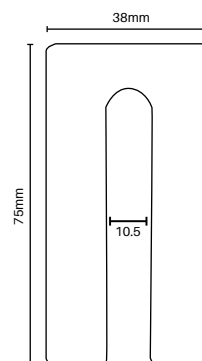

Available 1mm
or 3mm thick

Driver bit

Order Code: **DB-PH3**

- Driver bit to suit Phillips #3 screw head



Square head driver bit

Order Code: **DB-SQ3.4**

- Driver bit to suit 3.4mm square screw head hole
- Suits panhead screws used with "C" brackets



Touch Up Paint

150g SPRAY CAN

Black or white finish



Order Code: **PAINT-B (Black)**

PAINT-W (White)

- Colour match touch up paint



ORDER CODES

Order Code	Description	Colours
BR-PANEL-1733-1000-B/W	BARR 50 x 25 Panel – 1000mm H x 1733mm W	
BR-PANEL-2205-1200-B/W	BARR 50 x 25 Panel – 1200mm H x 2205mm W	
BR-PANEL-1969-1800-B/W	BARR 50 x 25 Panel – 1800mm H x 1969mm W	
BR-GATE-0975-1200-B/W	BARR 50 x 25 Gate – 1200mm H x 975mm W	
BR-GATE-0975-1800-B/W	BARR 50 x 25 Gate – 1800mm H x 975mm W	
BR-1280-BP-B/W	Post with welded base plate – 1280mm long	
BR-1800-B/W	Post – 1800mm long	
BR-2500-B/W	Post – 2500mm long	
BR-DR-B/W	Dress ring	
BR-TCA-B/W	BARR Aluminium Top Cap	
BR-BR25-B/W-4PK	BARR 'C' Bracket Kit	
BR-BR60-B/W-4PK	BARR Extended 'C' Bracket Kit	
BR-BRCAP-B/W-4PK	Bracket cap – 4 pack	
BR-1000-GC-2PK-B/W	BARR Gate Converter – 1000mm high	
BR-1200-GC-2PK-B/W	BARR Gate Converter – 1200mm high	
BR-1800-GC-2PK-B/W	BARR Gate Converter – 1800mm high	
BR-DC-2P-B/W	BARR 2 Part Domical Cover	



For fencing accessories/hinges/latches refer pages 64-87

ASSEMBLY OVERVIEW OF BARR SYSTEM

SEAMLESS INTEGRATION OF PANELS & POSTS WITH MATCHING 50x25MM PROFILES

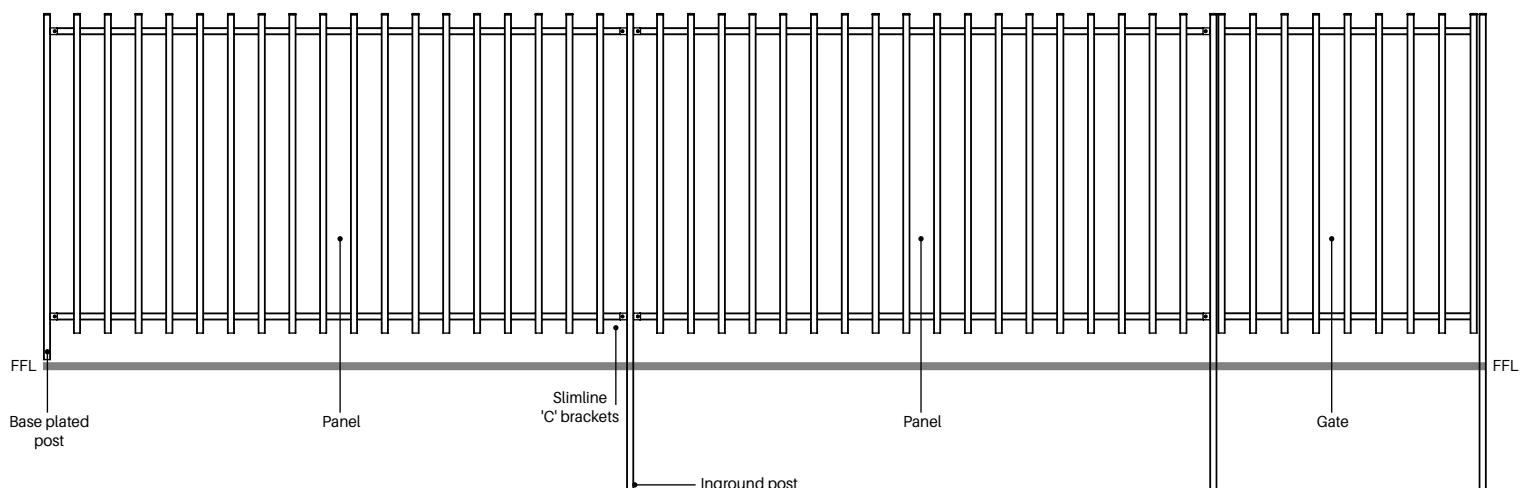

Images & drawings are not to scale